



### Easy, Simple and quick to connect and install

The pipe and the joints can be assembled quickly without any preparation. Quick assembly, No welding, agglutination or intertwist is needed. No deep training is needed. Light and easy to cut pipes and to operate on site.



### Perfect compatibility

AIRPIPE can connect perfectly to the female thread, male thread and flange joints.



### Strong, Long life, and beautiful

The material and construction design of AIRPIPE make itself possess the capability to resist corrosion, vibration, hot temperature and any harsh environment. Therefore the air quality is preserved throughout the whole network up to the point of use, protecting the downstream equipment and the manufacturing process.



# FULL PERFORMANCE COMPRESSED AIR PIPE SYSTEM

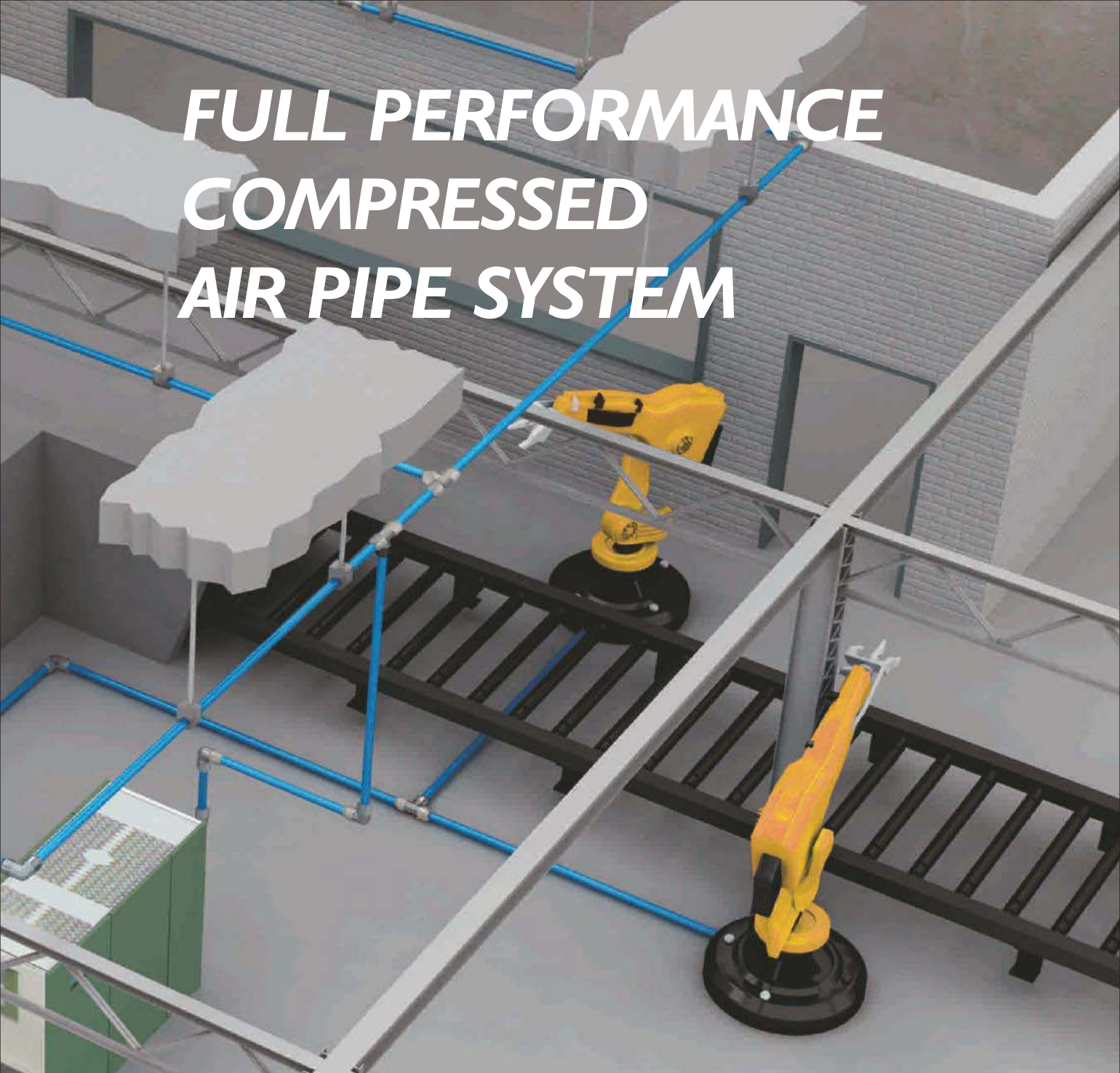

## Mature technology perfect quality

The compressed air pipe system plays an important role in the entire line of the production .AIRPIPE system adopts the unique technology, proving the high quality compressed air under the suitable pressure environment, reducing the energy cost for the client. The spare parts for AIRPIPE system are more flexible for installation and can meet different design and production requirements from different customers.



## Super flexibility

AIRPIPE spare parts can be dismantled and used repeatedly,which can adapt to the changing environment. Shunt device and branch pipelines can be added quickly at any time,which can adapt to the adjustment of the production line. The header slopes in the direction of the airflow of the airflows towards to low point so that the condensed water can be removed from pipe system.



## Corrosion-Resistant Low Pressure Drop

High quality and smooth inner surface will never rust,it ensures a stable flow of compressed air and guarantees the safety at the point of use.The high performance of “O” sealing ring ensures excellent seal and no leakage optimum design and the low friction inner surface eliminate the airflow restriction,reducing the pressure drop efficiently.



## Technological innovation of valve

Full volume design makes AIRPIPE energy saving and quick for installation.



# Warranty and Certifications



## 10 Year Limited Warranty:

- AIRpipe warrants its products to be free of defects in material and workmanship for a period of ten years from the date of product purchase. No other warranties, express or implied are made by AIRpipe. This limitation explicitly excludes any implied warranty of merchantability or fitness for a particular purpose. The sole remedy for breach of this warranty of material and workmanship or for negligence in manufacture or design is limited to replacement or repair, at the sole discretion of AIRpipe. In no event shall AIRpipe, its parent, and sister companies be liable for indirect, special, incidental or consequential damages of any kind. No allowance will be made for repairs made by the purchaser.
- AIRpipe does not warrant the design, assembly or installation of the system, but only the components listed within AIRpipe LOGO. AIRpipe is not responsible for improper assembly, installation, or for any modifications of the product.

The warranty is void upon

- failure to follow assembly or installation guidelines;
- alteration, misuse or abuse of, or damage to the products;
- operation beyond the design range, excessive pressure, stress, or mishandling in any way;
- use other than for the intended purpose or in a manner other than specified by AIRpipe.

## Engineering standards:

- ASME B31.1 & B31.3
- UL94HB
- UL94V-2
- TUV
- CE & EN
- PED 2014/68/EU
- TS
- ASTM B241, EN755-8, GB/T4437.1-2000, JIS H4080

## Certifications and Compliances:

- ISO 9001
- ISO 14001
- ISO 8573-1
- ASME, UL, TUV, CRN, CE, EN and TS



AIRPIPE	D1
2009 1060 00	20
2009 2060 00	25
2009 4060 00	40
2009 5060 00	50

\* E.g: The code 2009 5060 00 is the sealing spare parts for DN50 connector (Including Seal liner, Seal ring, Inner liner, Gripping teeth, and Clamping plate.)



## Grab Ring Clamping Style Connection DN20 - DN50mm

- Metal clamshell union connector, quick install & reassembly.
- Grab ring with surface contact, no shrinking on inner diameter.
- Surface contact, active concentric sealing, leak free.
- Superior reliability & longevity.

# CONTENT

Rigid Aluminium Pipe		04
Connector & Elbow		05
Connector Clamp type (20mm to 50mm)		11
Quick Drop		14
Valve		15
Flange		17
Flexible Hose		19
Fixture Accessories		20
Tool		25
Important Installation Guide		27
Pneumatic Accessories		40



# AIRPIPE

## Item Description

---

Example

2009 5417 00

■ The 1st number to the 4th number is set to differentiate the future series products.

■ The 9th to 10th number is set to differentiate the future logistics packaging.

---

### The 5th number is the inlet size

0 for < DN20 1 for DN20 2 for DN25 3 for DN32 4 for DN40 5 for DN50 6 for DN63 7 for DN80 8 for DN100 9 for DN150 A for DN200

As the above example 2009 5417 00, the 5th number is 5, that means the inlet size is DN50.

---

### The 6th number is the outlet size

0 for < DN20 1 for DN20 2 for DN25 3 for 1" 1 1/4" 4 for DN40 5 for DN50 6 for DN63 7 for DN80 8 for DN100 9 for DN150 A for DN200

As the above example 2009 5417 00, the 6th number is 4, that means the outlet size is DN40.

---

### The 7th and 8th is the AIRPIPE series

00 6m Aluminum Pipe 01S Bend 02 Pipe to Pipe Joint 03 90° Elbow 04 45° Elbow 05 Equal Tee 06 End Cap 07 Reducing Tee 10 Quick Drop 11 Threaded Quick Drop 13 Inner Thread 90° Elbow 15 outer Thread 90° Elbow 17 Male Threaded Nipple Socket 19 Female Threaded Nipple Socket 21 Reducing Pipe To Pipe Joint 23 Wall Mounted Joint 22/27 Tube Clip/gasket 28/29/40-45 Tools 30-39/50 Installation Accessories 51 Quick Valve 55 High Pressure Hose 60 Spare Parts for the Connector 63 3m Aluminum Pipe 70 Flange 73 Copper Valve 80/81 Check Valve

As the above example 2009 5417 00, the 7th and 8th is 17, that means the product is male threaded aluminum joint.

# Technical Specifications

<b>Suitable fluids</b>	<b>Max. Working pressure</b>	<b>Vacuum</b>
<ul style="list-style-type: none"> <li>Compressed air (dry, wet, lubricated)</li> <li>Vacuum</li> <li>Inert gases (including Argon, Helium, Nitrogen, CO2 mixes)</li> </ul>	<ul style="list-style-type: none"> <li>Max. working pressure: 16bar. *(Max. working pressure for DN200 is 13bar.)</li> </ul>	<ul style="list-style-type: none"> <li>Vacuum: 1mbar (absolute pressure)</li> </ul>
<b>Resistance to</b>		<b>Recyclability</b>
<ul style="list-style-type: none"> <li>Corrosion</li> <li>Aggressive environments</li> <li>Mechanical shocks</li> <li>Thermal variations</li> <li>Ultraviolet (U.V.)</li> <li>Compressor oil carry over (mineral/synthetic)</li> </ul>		<ul style="list-style-type: none"> <li>100% recyclable.</li> </ul>

## PRODUCTS

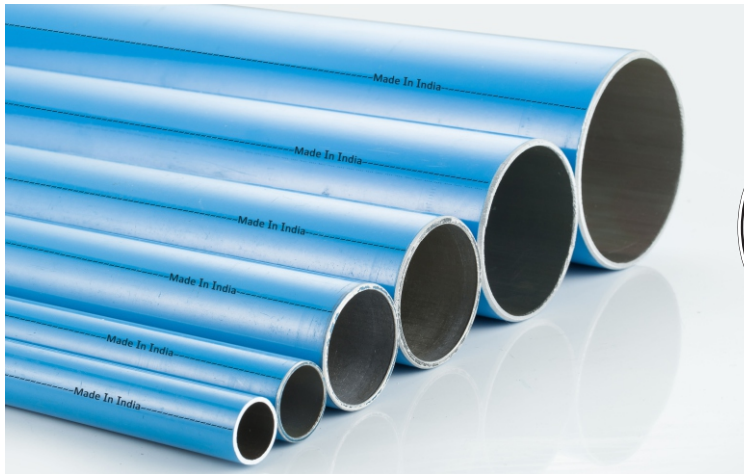

AIRPIPE	DN20 3/4"	DN25 1"	DN32 1.26"	DN40 1 1/2"	DN50 2"	DN63 2 1/2"	DN80 3"	DN100 4"	DN150 6"	DN200 8"
Aluminum Pipe (2.9m/5.8m)	•	•	•	•	•	•	•	•	•	•
S Bend	•	•								
Pipe Clip	•	•	•	•	•	•	•	•	•	•
Gasket	•	•	•	•	•	•				

AIRPIPE	DN20 3/4"	DN25 1"	DN32 1.26"	DN40 1 1/2"	DN50 2"	DN63 2 1/2"	DN80 3"	DN100 4"	DN150 6"	DN200 8"
Pipe to Pipe connector	•	•	•	•	•	•	•	•	•	•
45° Elbow	•	•	•	•	•	•	•	•	•	•
90° Elbow	•	•	•	•	•	•	•	•	•	•
Tee	•	•	•	•	•	•	•	•	•	•
Reducer Tee		•	•	•	•	•	•	•	•	•
Reducer connector		•	•	•	•	•	•	•	•	•
End Cap	•	•	•	•	•	•	•	•	•	•
Nipple Socket (Male thread)	•	•	•	•	•	•				
Nipple Socket (Female thread)	•	•	•	•	•					
Quick Drop		•	•	•	•	•	•	•	•	•
Quick Plug Valve	•	•	•	•	•	•	•	•	•	•
Flange connector						•	•	•	•	•
Flange with Female Thread		•		•	•	•	•	•	•	•
Hose	•	•	•	•	•	•	•	•	•	•

# Rigid aluminum pipe

- Clean air certified (ISO 8573-1)
- Optimum flow performance
- Lightweight
- High quality powder coated exterior
- Extruded marine grade aluminum
- Suitable for Compressed air, oil-free or lubricated, vacuum, and inert gases (Nitrogen, Argon, Helium, CO<sub>2</sub>)

- Max.working pressure: 16bar  
Max.working pressure for DN 200 is 13bar
- Vacuum: 1mbar (absolute pressure)
- Working temperature: -4°F up to +176°F  
-20°C up to +80°C

## Aluminum alloy Pipe : ● Standard



AIRPIPE Part No.	Diameter	OD( mm)	ID(mm)	L(M)
2009 1000 00 30100010001	20	20.1	17.5	6
2009 1063 00	20	20.1	17.5	3
2009 2000 00 30100020001	25	25.1	22.5	6
2009 2063 00 30100020101	25	25.1	22.5	3
2016 3000 00 30100030001	32	32.2	29.0	6
2016 3063 00 30100030101	32	32.2	29.0	3
2009 4000 00 30100040001	40	40.1	36.5	6
2009 4063 00 30100040101	40	40.1	36.5	3
2009 5000 00 30100050001	50	50.1	45.7	6
2009 5063 00 30100050101	50	50.1	45.7	3
2014 6000 00 30100060001	63	67.6	63	6
2014 6063 00 30100060101	63	67.6	63	3
2014 7000 00 30100070001	80	84.8	80.0	6
2014 7063 00 30100070101	80	84.8	80.0	3
2009 8000 00 30100080001	100	101.8	96.8	6
2009 8063 00 30100080101	100	101.8	96.8	3
2009 9000 00 30100090001	150	153	147.5	6
2009 9063 00 30100100101	150	153	147.5	3
2012 A00000 30100100001	200	205	198.6	5.8
2012 A063 00 30100110101	200	205	198.6	2.9

## Aluminum alloy Pipe : ●●●● (as per required)



2009 1062 00 30100010002	20	20.1	17.5	6
2009 1064 00 30100010102	20	20.1	17.5	3
2009 2062 00 30100020002	25	25.1	22.5	6
2009 2064 00 30100020102	25	25.1	22.5	3
2016 3062 00 30100030002	32	32.2	29.0	6
2016 3064 00 30100030102	32	32.2	29.0	3
2009 4062 00 30100040002	40	40.1	36.5	6
2009 4064 00 30100040102	40	40.1	36.5	3
2009 5062 00 30100050002	50	50.1	45.7	6
2009 5064 00 30100050102	50	50.1	45.7	3
2014 6062 00 30100060002	63	67.6	63	6
2014 6064 00 30100060102	63	67.6	63	3
2014 7062 00 30100070002	80	84.8	80.0	6
2014 7064 00 30100070102	80	84.8	80.0	3
2009 8062 00 30100080002	100	101.8	96.8	6
2009 8064 00 30100080102	100	101.8	96.8	3
2009 9062 00 30100090002	150	153	147.5	6
2009 9064 00 30100100102	150	153	147.5	3
2012 A06200 30100100002	200	205	198.6	5.8
2012 A064 00 30100110102	200	205	198.6	2.9

## S Bend

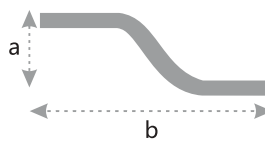

AIRPIPE Part No.	Diameter	a	b
2009 1001 00 30101010001	20	170	0.5
2009 2001 00 30101020001	25	120	0.5

\*S bend is often used to fix drop legs closer to the wall when the main ring is installed further away from the wall.



# Connector (Standard)

## Features

- AIRPIPE provides various connectors to break the limitation of the conventional pipe and fittings in the construction structure.
- Quick connecting
- Full volume flow design
- To be able to dismantle, reassemble and reuse.
- Non-flammable materials
- The whole piping can keep the same flow diameter

## Aluminum pipe to pipe Connector

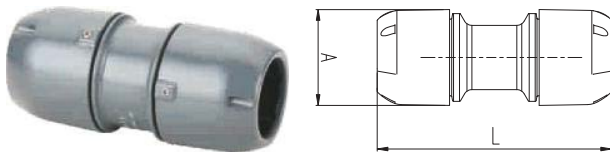

AIRPIPE Part No.		Diameter	L	A
2012 1002 00	30202010003	20	96	38
2012 2002 00	30202020003	25	107	46
2016 3002 00	30202030001	32	121	54
2012 4002 00	30202040003	40	138	64
2012 5002 00	30202050003	50	161	78

## Aluminum pipe to pipe Connector

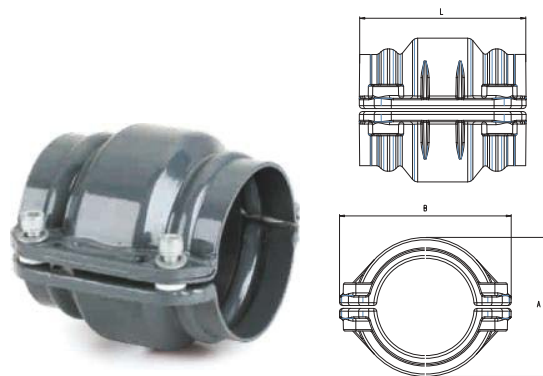

AIRPIPE Part No.		Diameter	L	A	B
2016 6002 00	30202060105	63	114	97	113
2017 7002 00	30202070108	80	114	114	137
2017 8002 00	30202080108	100	140	131	151
2018 9002 00	30202100105	150	146	184	226
2018 A002 00	30202110105	200	134	236	280

## Aluminum 90° Elbow

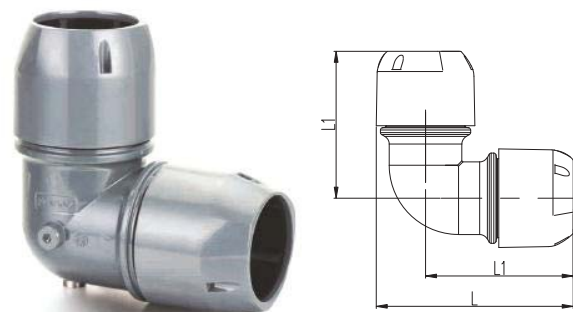

AIRPIPE Part No.		Diameter	L	L1
2012 1003 00	30203010001	20	81	62
2012 2003 00	30203020001	25	92	68
2016 3003 00	30203030001	32	113	85
2012 4003 00	30203040001	40	125.5	92.5
2012 5003 00	30203050001	50	141.5	102

## Aluminum 90° Elbow

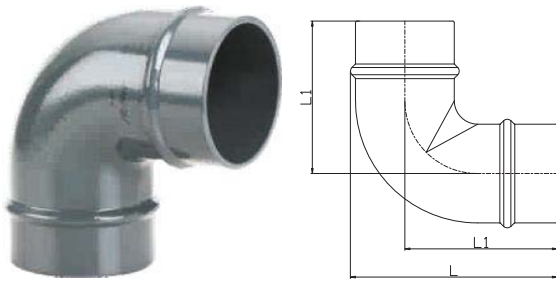

AIRPIPE Part No.	Diameter	L1	L
2014 6003 00 30203060001	63	143	105
2014 7003 00 30203070001	80	156	110
2012 8003 00 30203080001	100	194	140
2012 9003 00 30203100001	150	265	185
2012 A003 00 30203110001	200	313	208

## Aluminum 45° Elbow

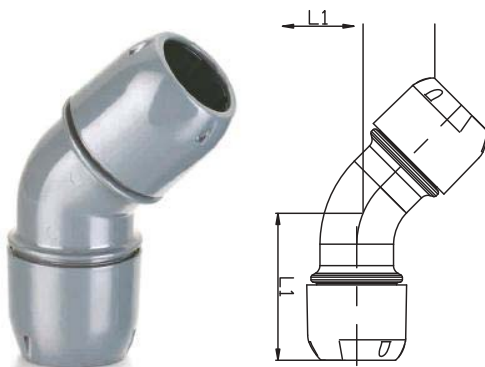

AIRPIPE Part No.	Diameter	L	L1
2012 1004 00 30204010001	20	102.5	54.5
2012 2004 00 30204020001	25	115.5	61
2012 4004 00 30204040001	40	152.5	79.5
2012 5004 00 30204050001	50	169.5	87

## Aluminum 45° Elbow

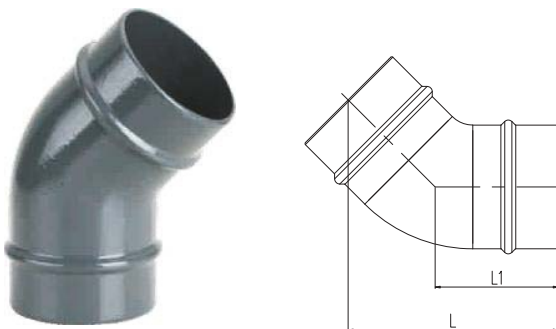

AIRPIPE Part No.	Diameter	L	L1
2015 6004 00 30204060001	63	137	80
2015 7004 00 30204070001	80	145	85
2015 8004 00 30204080001	100	180	105
2015 9004 00 30204100001	150	215	126
2015 A004 00 30204110001	200	230	135

## Aluminum Equal Tee

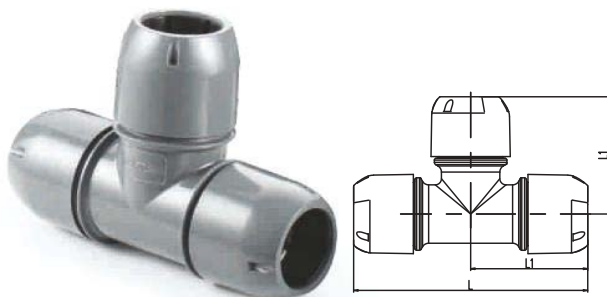

AIRPIPE Part No.	Diameter	L	L1
2012 1005 00 30205010001	20	126	63
2012 2005 00 30205020001	25	156	78
2016 3005 00 30205030001	32	160	80
2012 4005 00 30205040001	40	188	94
2012 5005 00 30205050001	50	214	107

## Aluminum Equal Tee

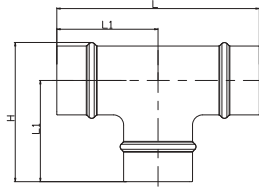

AIRPIPE Part No.	Diameter	L	L1	H
2014 6005 00 30205060001	63	200	100	137
2014 7005 00 30205070001	80	220	110	156
2014 8005 00 30205080001	100	262	131	186
2014 9005 00 30205100001	150	332	170	250
2012 A005 00 30205110001	200	375	187.5	293

## Aluminum Reducing Tee

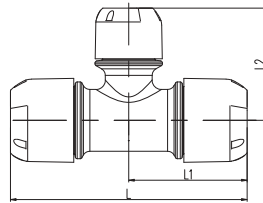

AIRPIPE Part No.	Diameter	L	L1	L2
2012 2107 00 30207020101	25X20	130	65	62
2016 3207 00 30207030201	32X25	151	75	73
2012 4207 00 30207040201	40X25	154	77	80
2016 4307 00 30207040301	40X32	174	87	88
2016 5307 00 30207050301	50X32	192	96	94
2012 5407 00 30207050401	50X40	192	96	95

## Aluminum Reducing Tee

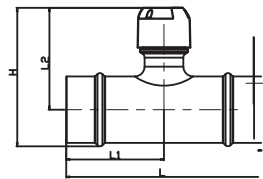

AIRPIPE Part No.	Diameter	L	L1	L2	H
2014 6407 00 30207060401	63X40	200	100	102	140
2014 6507 00 30207060501	63X50	200	100	113	151
2014 7407 00 30207070401	80X40	190	95	109	155
2014 7507 00 30207070501	80X50	200	100	121	173
2009 8407 00 30207080401	100X40	210	105	125	178
2014 8507 00 30207080501	100X50	226	113	129	184
2009 9407 00 30207100401	150X40	230	115	140	220
2009 9507 00 30207100501	150X50	236	118	145	225
2012 A407 00 30207110401	200X40	240	120	155	260
2012 A507 00 30207110501	200X50	240	120	160	265

## Aluminum Reducing Tee

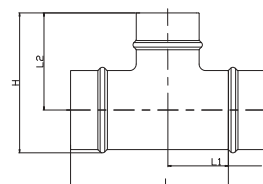

AIRPIPE Part No.	Diameter	L	L1	L2	H
2014 7607 00 30207070601	80X63	210	105	105	151
2014 8607 00 30207080602	100X63	236	118	118	172
2014 8707 00 30207080702	100X80	246	123	121	175
2014 9607 00 30207100601	150X63	242	121	150	230
2014 9707 00 30207100701	150X80	226	131	147	227
2014 9807 00 30207100801	150X100	272	136	162	242
2014 A607 00 30207110601	200X63	240	120	170	276
2014 A707 00 30207110701	200X80	256	128	171	276
2012 A807 00 30207110801	200X100	276	138	182	288
2014 A907 00 30207111001	200X150	344	172	182	288



## Aluminum Reducing Pipe to Pipe Joint

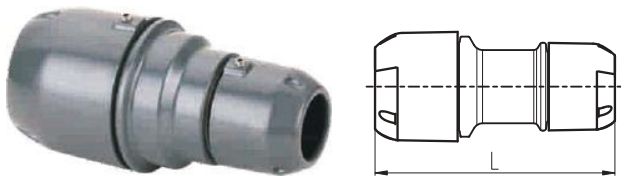

<i>AIRPIPE</i> Part No.	Diameter	L
2012 2121 00 30221020101	25x20	102
2016 3221 00 30221030201	32x25	115
2012 4221 00 30221040201	40X25	122
2016 4321 00 30221040301	40x32	130
2012 5221 00 30221050201	50x25	156
2012 5421 00 30221050401	50X40	160

## Aluminum Reducing Pipe to Pipe Joint

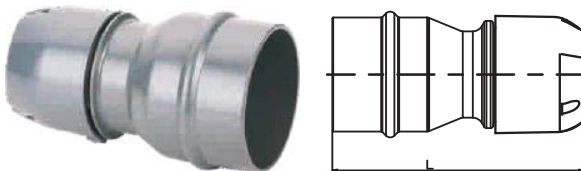

<i>AIRPIPE</i> Part No.	Diameter	L
2014 6421 00 30221060401	63x40	124
2014 6521 00 30221060501	63X50	126
2014 7521 00 30221070501	80x50	155

## Aluminum Reducing Pipe to Pipe Joint

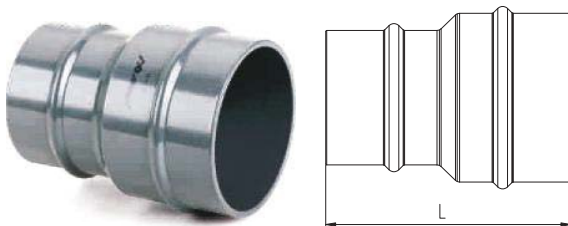

<i>AIRPIPE</i> Part No.	Diameter	L
2014 7621 00 30221070601	80X63	126
2014 8621 00 30221080601	100X63	152
2014 8721 00 30221080701	100x80	141
2014 9721 00 30221100701	150X80	155
2012 9821 00 30221100801	150X100	172
2012 A921 00 30221111001	200X150	170

## Aluminum End Cap

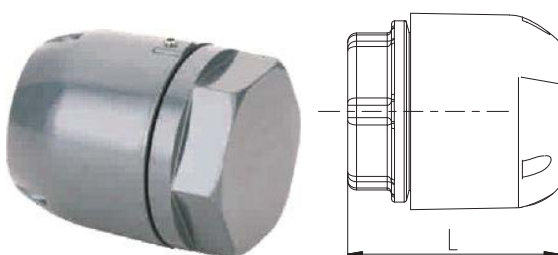

<i>AIRPIPE</i> Part No.	Diameter	L
2012 1006 00 30206010001	20	51
2012 2006 00 30206020001	25	57
2016 3006 00 30206030001	32	69
2012 4006 00 30206040001	40	74
2012 5006 00 30206050001	50	86

## Aluminum End Cap

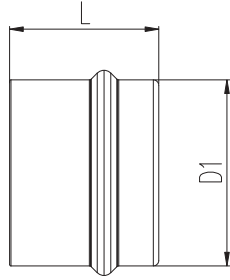

AIRPIPE Part No.	Diameter	L	D1
2014 6006 00 30206060001	63	54	68
2014 7006 00 30206070001	80	55	85.4
2012 8006 00 30206080001	100	70	101.8
2012 9006 00 30206100001	150	70	153
2012A006 00 30206110001	200	70	205

## Aluminum 90° Elbow ( Male Thread)

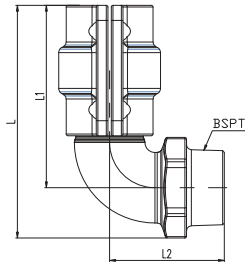

AIRPIPE Part No.	Diameter	L	L1	L2	Thread size (BSP)
AE15 1115 99 30215010101	20	95	79	49	3/4"
AE15 1015 99 30215010001	20	95	79	49	1/2"
AE15 2215 99 30215020201	25	102	82	52	1"
AE15 2015 99 30215020001	25	102	82	52	1/2"
AE15 4415 99 30215040401	40	141	109	69	1-1/2"
AE15 5515 99 30215050501	50	151	114	74	2"

Note: Be suitable for connecting with the outlet of Air Compressor  
Cold dryer and strainer.etc.

## Aluminum 90° Elbow ( Female Thread)

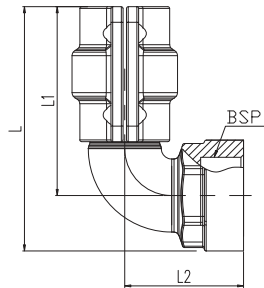

AIRPIPE Part No.	Diameter	L	L1	L2	Thread size (BSP)
AE15 1113 99 30213010101	20	95	79	49	3/4"
AE15 1013 99 30213010001	20	95	79	49	1/2"
AE15 2213 99 30213020201	25	102	82	52	1"
AE15 2013 99 30213020001	25	102	82	52	1/2"
AE15 4413 99 30213040401	40	141	109	69	1-1/2"
AE15 5513 99 30213050501	50	151	114	74	2"

Note: Be suitable for connecting with the outlet of Air Compressor  
and Cold dryer.

## Aluminum Nipple Socket ( Female Thread)

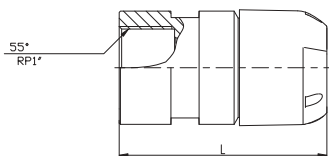

AIRPIPE Part No.	Diameter	L	Thread size (BSP)
2012 1019 00 30219010001	20	63	1/2"
2009 1119 00 30219010101	20	71	3/4"
2012 2019 00 30219020001	25	68	1/2"
2009 2219 00 30219020201	25	85	1"
2016 3319 00 30219030301	32	84	1-1/4"
2012 4419 00 30219040401	40	124	1-1/2"
2012 5519 00 30219050501	50	141	2"

## Aluminum Nipple Socket ( Female Thread)

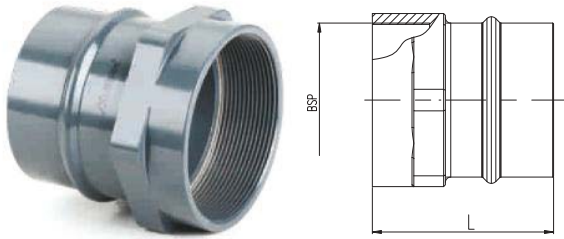

<b>AIRPIPE</b> Part No.	Diameter	L	Thread size (BSP)
2014 6619 00 30219060601	63	93	2-1/2"
2014 7719 00 30219070701	80	100	3"

## Aluminum Nipple Socket ( Male Thread)

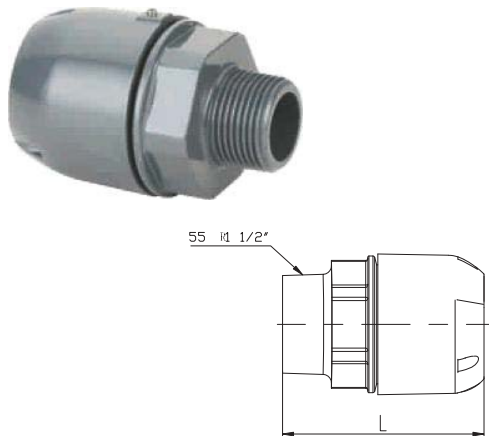

<b>AIRPIPE</b> Part No	Diameter	L	Thread size (BSP)
2009 1017 00 30217010001	20	69	1/2"
2009 1117 00 30217010101	20	71	3/4"
2009 2017 00 30217020001	25	81	1/2"
2009 2117 00 30217020101	25	82	3/4"
2009 2217 00 30217020201	25	85	1"
2016 3117 00 30217030101	32	85	3/4"
2016 3217 00 30217030201	32	87	1"
2016 3317 00 30217030301	32	86	1-1/4"
2012 4217 00 30217040201	40	124	1"
2012 4317 00 30217040301	40	124	1-1/4"
2012 4417 00 30217040401	40	124	1-1/2"
2012 5417 00 30217050401	50	140	1-1/2"
2012 5517 00 30217050501	50	144	2"

## Aluminum Nipple Socket ( Male Thread)

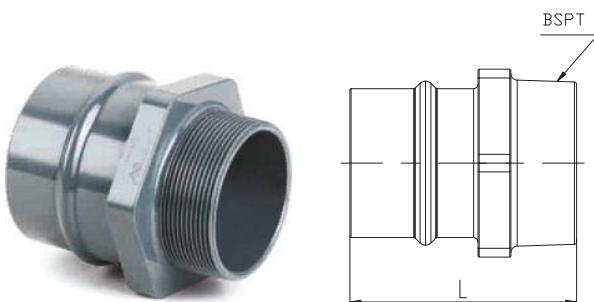

<b>AIRPIPE</b> Part No.	Diameter	L	Thread size (BSP)
2014 6517 00 30217060501	63	99	2"
2014 6617 00 30217060601	63	105	2-1/2"
2014 7617 00 30217070601	80	107	2-1/2"
2014 7717 00 30217070701	80	110	3"



# Connection Technology (on Requirement)

AIRpipe innovative modular technology enables rapid and easy assembly via quick connection of fittings to the aluminum pipe. This technology takes into account the specific requirement of each diameter to provide the user with a secure connection.

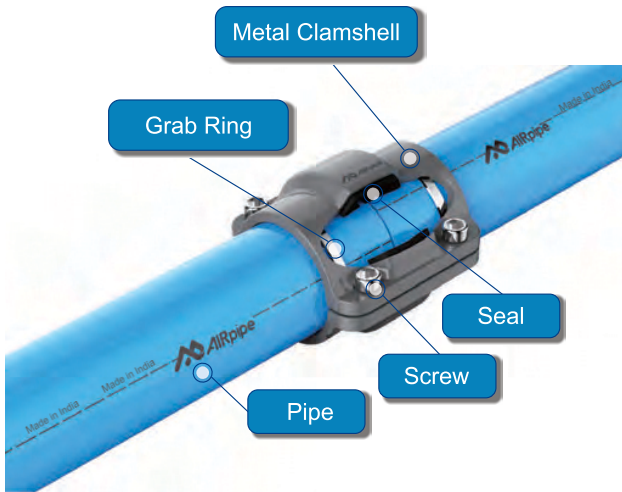

## Grab Ring Clamping Style Connection DN20 - DN50mm

- Metal clamshell union connector, quick install & reassembly.
- Grab ring with surface contact, no shrinking on inner diameter.
- Surface contact, active concentric sealing, leak free.
- Superior reliability & longevity.

## Pipe to Pipe Connector

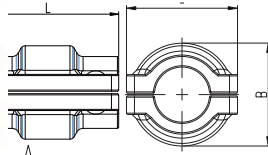

AIRpipe Part No.	Nominal Diameter	L	A	B
AE15 1002 00 30202010001	20	59	36	41
AE15 2002 00 30202020001	25	59	42	44
AE15 4002 00 30202040001	40	78	69	60
AE15 5002 00 30202050001	50	79	80	74

## Equal 90° Elbow

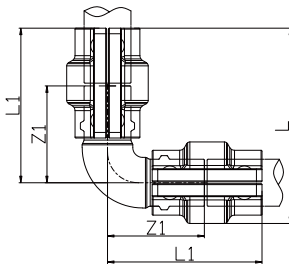

AIRpipe Part No.	Nominal Diameter	L1	L	Z1
AE15 1003 99 30203010002	20	80	100	61
AE15 2003 99 30203020002	25	83	105	67
AE15 4003 99 30203040002	40	109	139	91
AE15 5003 99 30203050002	50	115	152	101

## Equal 45° Elbow

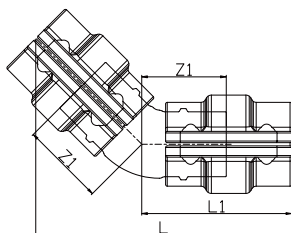

AIRpipe Part No.	Nominal Diameter	L	L1	Z1
AE15 1004 99 30204010002	20	118	70	39
AE15 2004 99 30204020002	25	119	71	40
AE15 4004 99 30204040002	40	159	92	52
AE15 5004 99 30204050002	50	162	95	54

## Equal Tee

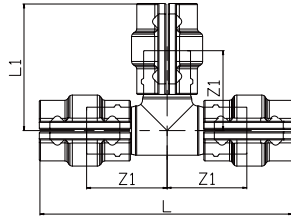

<i>AIRpipe</i> Part No.	Nominal Diameter	L	L1	Z1
AE15 1005 99 30205010002	20	160	80	49
AE15 2005 99 30205020002	25	166	83	52
AE15 4005 99 30205040002	40	218	109	69
AE15 5005 99 30205050002	50	230	115	74

## Reducing Tee

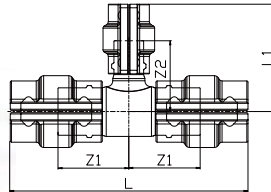

<i>AIRpipe</i> Part No.	Nominal Diameter	L	Z1	Z2	L1
AE15 2107 99 30207020102	25X20	160	50	51	80
AE15 4207 99 30207040202	40X25	200	61	60	90
AE15 5207 99 30207050201	50x25	220	70	71	101
AE15 5407 99 30207050402	50X40	220	70	74	114

## Reducing Tee

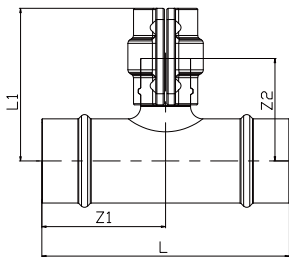

<i>AIRpipe</i> Part No.	Nominal Diameter	L	Z1	L1	Z2
AE15 6407 99 30207060402	63x40	200	100	122	83
AE15 6507 99 30207060502	63x50	200	100	123	83
AE15 7407 99 30207070402	80x40	190	100	132	92
AE15 7507 99 30207070502	80x50	200	106	133	92
AE15 8507 99 30207080502	100x50	226	118	141	100

\*Use (2) union connectors.

## Female Threaded Adapter

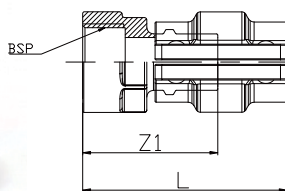

<i>AIRpipe</i> Part No.	Nominal Diameter	L	BSP	Z1
AE16 1019 99 30219010002	20	88	½"	57
AE15 1119 99 30219010102	20	88	¾"	58
AE16 2019 99 30219020002	25	90	½"	59
AE15 2219 99 30219020202	25	90	1"	60
AE15 4419 99 30219040402	40	119	1-½"	78
AE15 5519 99 30219050502	50	120	2"	79

## Male Threaded Adapter

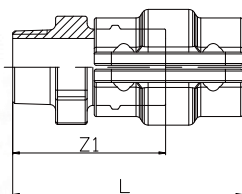

<i>AIRpipe</i> Part No.	Nominal Diameter	L	Z1	BSP
AE15 1017 99 302170100 02	20	90	59	½"
AE15 1117 99 30217010102	20	91	60	¾"
AE16 2017 99 30217020002	25	92	60	½"
AE15 2117 99 30217020102	25	93	60	¾"
AE15 2217 99 30217020202	25	93	62	1"
AE15 4217 99 30217040202	40	119	78	1"
AE15 4317 99 30217040302	40	122	81	1-¼"
AE15 4417 99 30217040402	40	122	81	1-½"
AE17 4517 99 30217040501	40	122	81	2"
AE15 5417 99 30217050402	50	122	81	1-½"
AE15 5517 99 30217050502	50	126	85	2"

## Lateral Equal Tee

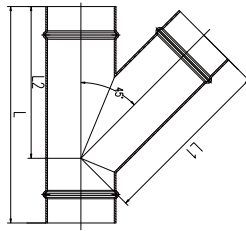

<i>AIRpipe</i> Part No.	Nominal Diameter	L	L1	L2
2016 6009 00 30209060001	63	238	184	163
2016 7009 00 30209070001	80	262	211	184
2016 8009 00 30209080001	100	305	246	213
2016 9009 00 30209100001	150	385	340	280
2016 A009 00 30209110001	200	459	400	347

\*Use (3) union connectors.

## Lateral Reducing Tee

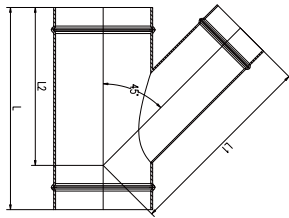

<i>AIRpipe</i> Part No.	Nominal Diameter	L	L1	L2
2016 8712 00 30212080701	100x80	282	226	202
2016 9712 00 30212100701	150x80	292	276	235
2016 9812 00 30212100801	150x100	312	300	244
2016 A812 00 30212110801	200x100	320	339	275
2016A912 00 30212111001	200x150	394	377	312

\*Use (3) union connectors.

## Reducing Pipe to Pipe Connector

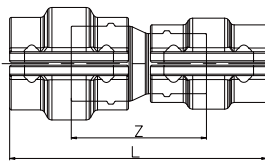

<i>AIRpipe</i> Part No.	Nominal Diameter	L	Z
AE15 2121 99 30221020102	25x20	130	67
AE15 4221 99 30221040202	40x25	156	84
AE16 5221 99 30221050202	50x25	160	86
AE15 5421 99 30221050402	50x40	172	91

## Reducing Pipe to Pipe Connector

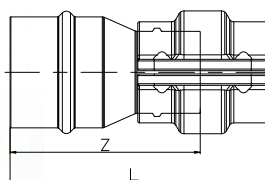

<i>AIRpipe</i> Part No.	Nominal Diameter	L	Z
AE16 6421 99 30221060402	63x40	156	116
AE15 6521 99 30221060502	63x50	157	117
AE15 7521 99 30221070502	80x50	158	117

\*Use a union connector.

## End Cap

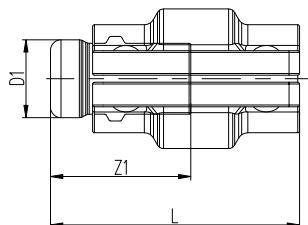

<i>AIRpipe</i> Part No.	Nominal Diameter	L	D1	Z1
Ae15 1006 99 30206010002	20	70	22	40
AE15 2006 99 30206020002	25	70	27	40
AE15 4006 99 30206040002	40	90	42	49
AE15 5006 99 30206050002	50	91	52	50



# Quick Drop

## Features

- The new generation quick drop can be used horizontally or vertically, connecting to a rigid pipe or a hose.
- High Volume Flow
- The complete water trap ensures the water will not enter the downstream branch
- It can be installed quickly. No need to cut the pipes.

## Aluminum Quick Drop



## Aluminum Quick Drop

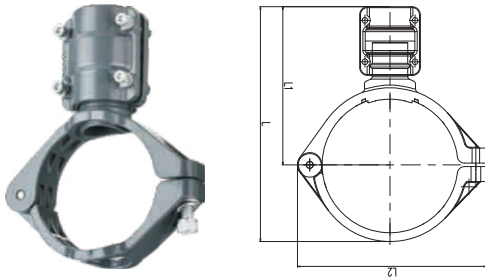

## Aluminum Quick Drop-Female Thread

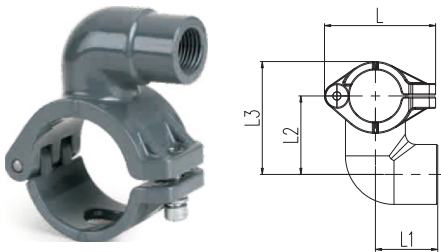

## Aluminum Quick Drop-Female Thread

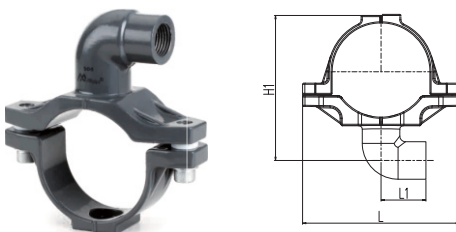

## Quick Drop (Straight Female)



AIRPIPE Part No.	DESCRIPTION OF GOODS
AE18 2110 99 30210020104	QUICK DROP, DN25-20
AE18 2210 99 30210020203	QUICK DROP, DN25-25
2016 3110 00 30210030102	QUICK DROP, DN32-20
AE18 4110 99 30210040104	QUICK DROP, DN40-20
AE18 4210 99 30210040204	QUICK DROP, DN40-25
AE17 5110 99 30210050101	QUICK DROP, DN50-20
AE17 5210 99 30210050201	QUICK DROP, DN50-25

AIRPIPE Part No.	DESCRIPTION OF GOODS
AE17 6110 99 30210060101	QUICK DROP, DN63-20
AE17 6210 99 30210060201	QUICK DROP, DN63-25
AE17 7110 99 30210070101	QUICK DROP, DN80-20
AE17 7210 99 30210070201	QUICK DROP, DN80-25
AE17 8110 99 30210080101	QUICK DROP, DN100-20
AE17 8210 99 30210080201	QUICK DROP, DN100-25
AE17 9110 99 30210100101	QUICK DROP, DN150-20
AE17 9210 99 30210100201	QUICK DROP, DN150-25
AE17 A210 99 30210110201	QUICK DROP, DN200-25

AIRPIPE Part No.	DESCRIPTION OF GOODS
AE15 8410 99 30210080401	QUICK DROP, DN100-40
AE15 9410 99 30210100401	QUICK DROP, DN150-40
AE15 9510 99 30210100501	QUICK DROP, DN150-50
AE15 A410 99 30210110401	QUICK DROP, DN200-40
AE15 A510 99 30210110501	QUICK DROP, DN200-50

Note: The products can be replaced with Reducing Tee (BA) marking "\*\*"

AIRPIPE Part No.	DN	BSP	L	L1	L2	L3
AE18 2011 00 30211020003	25	½"	54	54	30	38
2016 3011 00 30211030002	32	½"	60	60	34	42
AE18 4011 00 30211040003	40	½"	72	72	42	45
AE18 4111 00 30211040103	40	¾"	72	72	42	45
2017 5011 00 30211050001	50	½"	83	83	46	54
2017 5111 00 30211050101	50	¾"	83	83	47	54

AIRPIPE Part No.	DN	BSP	L1	L	H
2017 6011 00 30211060001	63	½"	65	126	112
2017 6111 00 30211060101	63	¾"	78	126	112
2017 7011 00 30211070001	80	½"	65	138	127
2017 7111 00 30211070101	80	¾"	78	138	127
2017 8011 00 30211080001	100	½"	54	170	150
2017 9011 00 30211100001	150	½"	55	219	201

AIRPIPE Part No.	DESCRIPTION OF GOODS
30211050003	QUICK DROP STRAIGHT THREAD FEMALE, DN50-1/2"
30211050103	QUICK DROP STRAIGHT THREAD FEMALE, DN50-3/4"
30211060002	QUICK DROP STRAIGHT THREAD FEMALE, DN63-1/2"
30211060102	QUICK DROP STRAIGHT THREAD FEMALE, DN63-3/4"
30211070002	QUICK DROP STRAIGHT THREAD FEMALE, DN80-1/2"
30211070102	QUICK DROP STRAIGHT THREAD FEMALE, DN80-3/4"
30211080003	QUICK DROP STRAIGHT THREAD FEMALE, DN100-1/2"
30211080101	QUICK DROP STRAIGHT THREAD FEMALE, DN100-3/4"
30211100003	QUICK DROP STRAIGHT THREAD FEMALE, DN150-1/2"
30211100101	QUICK DROP STRAIGHT THREAD FEMALE, DN150-3/4"
30211110001	QUICK DROP STRAIGHT THREAD FEMALE, DN200-1/2"
30211110101	QUICK DROP STRAIGHT THREAD FEMALE, DN200-3/4"

# Valve

## Features

- AIRPIPE ball valve and butterfly valve can be installed in the piping and some important position such as outlet of compressor and upstream of pneumatic tools. Good for the separation, adjustment and maintenance.
- Quick install
- Provide a range of male threaded valve to better connect the system.
- The type of Thread can be BSP or NPT.

## Quick plug ball valve (Female Thread)



## Quick plug ball valve (male Thread)



## Quick plug ball valve(Two head /Female Thread)



## Non-Valved Wall Bracket



## Quick plug ball valve



AIRPIPE Part No.	DESCRIPTION OF GOODS
AI15 1151 99 30451010101	BRASS VALVE, DN20-TWO 1/2" FEMALE THREAD
AI15 1251 99 30451010201	BRASS VALVE, DN20-1/2" FEMALE THREAD
AI15 2151 99 30451020101	BRASS VALVE, DN25-TWO 1/2" FEMALE THREAD
AI15 2251 99 30451020201	BRASS VALVE, DN25-1" FEMALE THREAD
AI15 2451 99 30451020401	BRASS VALVE, DN25-1/2" FEMALE THREAD
2016 3251 00 30451030202	BRASS VALVE, DN32-1-1/4" FEMALE THREAD
AI15 4451 99 30451040401	BRASS VALVE, DN40-1-1/2" FEMALE THREAD
AI15 5551 99 30451050501	BRASS VALVE, DN50-2" FEMALE THREAD

AIRPIPE Part No.	DESCRIPTION OF GOODS
AI15 1351 99 30451010301	BRASS VALVE, DN20-3/4" MALE THREAD
AI15 2351 99 30451020301	BRASS VALVE, DN25-1" MALE THREAD
2016 3351 00 30451030302	BRASS VALVE, DN32-1-1/4" MALE THREAD
AI15 4351 99 30451040301	BRASS VALVE, DN40-1-1/2" MALE THREAD
AI15 5351 99 30451050301	BRASS VALVE, DN50-2" MALE THREAD

AIRPIPE Part No.	DESCRIPTION OF GOODS
AI16 1551 99 30451010501	BRASS VALVE, DN20-TWO 1/2" FEMALE THREAD, 75°
AI16 2551 99 30451020501	BRASS VALVE, DN25-TWO 1/2" FEMALE THREAD, 75°

AIRPIPE Part No.	DESCRIPTION OF GOODS
AE 17 1123 99 30223010101	DN20, ONE-PORT 1/2", FEMALE, 45°
AE17 2123 99 30223020101	DN25, ONE-PORT 1/2", FEMALE, 45°
AE17 1023 99 30223010001	DN20, TWO-PORT 1/2", FEMALE, 45°
AE17 2023 99 30223020001	DN25, TWO-PORT 1/2", FEMALE, 45°

AIRPIPE Part No.	DESCRIPTION OF GOODS
AI15 1051 99 30451010001	BRASS VALVE, DN20
AI15 2051 99 30451020001	BRASS VALVE, DN25
2016 3051 00 30451030002	BRASS VALVE, DN32
AI15 4051 99 30451040001	BRASS VALVE, DN40
AI15 5051 99 30451050001	BRASS VALVE, DN50

AIRPIPE Part No.	DESCRIPTION OF GOODS
30452060001	BRASS VALVE, DN63
30452060601	BRASS VALVE, DN63-2 1/2" FEMALE
30452060301	BRASS VALVE, DN63-2 1/2" MALE

## ball valve



- Ball valve (Male Thread)
- Ball valve (Female Thread)



- Ball valve (Male Thread-- Female Thread)

## New Threaded Ball Valve



- Threaded male Ball Valve DN6351 - 2 1/2"
- Threaded Female Ball Valve DN6651 - 2 1/2"

## Butterfly Valve



- DN63 butterfly Valve

## Swing Check Valve



## Lock Ball Valve



AIRPIPE Part No.	D1 ( BSP)	D2 ( BSP)	Connector
AI 15 0073 00 30473000001	½"	½"	Female Thread
AI 15 0173 00 30473010001	¾"	¾"	Female Thread
AI 151073 00 30473000101	½"	½"	Male Thread
AI 15 1173 00 30473010101	¾"	¾"	Male Thread
AI 15 0273 00 30473000201	½"	½"	Male Thread-- Female Thread
AI 15 1273 00 30473010201	¾"	¾"	Male Thread-- Female Thread
AI 15 2073 00 30473020001	1"	1"	Female Thread
AI 15 4073 00 30473040001	1-½"	1-½"	Female Thread
AI 15 5073 00 30473050001	2"	2"	Female Thread

AIRPIPE Part No.	DESCRIPTION OF GOODS
2018 6351 00 30451060301	Threaded Male Ball Valve DN -63 - 2-½"
2018 6651 00 30451060601	Threaded Female Ball Valve DN -63 - 2-½"

AIRPIPE Part No.	Diameter	L1	Material of valve	Remark
2015 6051 00 30251060001	63	188	Cast Iron	Need to match two Pipe to Pipe connector
2014 6151 00 30251060101	63	188	Stainless steel	
2015 7051 00 30251070001	80	210	Cast Iron	
2014 7151 00 30251070101	80	210	Stainless steel	
2015 8051 00 30251080001	100	236	Cast Iron	
2015 9051 00 30251100001	150	256	Cast Iron	
2015 A051 00 30251110001	200	278	Cast Iron	
2015 8151 00 30251080101	100	236	Stainless steel	
2015 9151 00 30251100101	150	256	Stainless steel	
2012 A151 00 30251110101	200	278	Stainless steel	

AIRPIPE Part No.	Diameter	Material of valve	Remark
2014 4480 00 30280040001	40	Cast Iron	Quick Plug
2014 5580 00 30280050001	50	Cast Iron	
2014 6680 00 30280060001	63	Cast Iron	Clamp
2014 7780 00 30280070001	80	Cast Iron	
2014 8880 00 30280080001	100	Cast Iron	
2014 9980 00 30280100001	150	Cast Iron	
2015 AA80 00 30280110001	200	Cast Iron	Quick Plug
2014 4481 00 30280040101	40	Stainless steel	
2014 5581 00 30280050101	50	Stainless steel	Clamp
2014 6681 00 30280060101	63	Stainless steel	
2014 7781 00 30280070101	80	Stainless steel	
2014 8881 00 30280080101	100	Stainless steel	
2014 9981 00 30280100101	150	Stainless steel	
2015 AA81 00 30280110101	200	Stainless steel	

Note : Used to stop the air backflow.

AIRPIPE Part No.	DESCRIPTION OF GOODS
AI15 1052 99 30452010001	LOCK BRASS VALVE, DN20
AI15 2052 99 30452020001	LOCK BRASS VALVE, DN25
AI15 4052 99 30452040001	LOCK BRASS VALVE, DN40
AI15 5052 99 30452050001	LOCK BRASS VALVE, DN50
AI15 1152 99 30452010101	LOCK BRASS VALVE, DN20-TWO 1/2" FEMALE
AI16 1552 99 30452010501	LOCK BRASS VALVE, DN20-1/2", TWO PORTS, FEMALE, 75°
AI15 1252 99 30452010201	LOCK BRASS VALVE, DN20-1/2" FEMALE
AI15 2152 99 30452020101	LOCK BRASS VALVE, DN25-TWO 1/2" FEMALE
AI16 2552 99 30452020501	LOCK BRASS VALVE, DN25-1/2", TWO PORTS, FEMALE, 75°
AI15 2252 99 30452020201	LOCK BRASS VALVE, DN25-1" FEMALE
AI15 2452 99 30452020401	LOCK BRASS VALVE, DN25-1/2" FEMALE
AI15 4452 99 30452040401	LOCK BRASS VALVE, DN40-1 1/2" FEMALE
AI15 5552 99 30452050501	LOCK BRASS VALVE, DN50-2" FEMALE
AI15 1352 99 30452010301	LOCK BRASS VALVE, DN20-3/4" MALE
AI15 2352 99 30452020301	LOCK BRASS VALVE, DN25-1" MALE
AI15 4352 99 30452040301	LOCK BRASS VALVE, DN40-1 1/2" MALE
AI15 5352 99 30452050301	LOCK BRASS VALVE, DN50-2" MALE

\*Union connectors included

# Flange

## Aluminum Flange connector

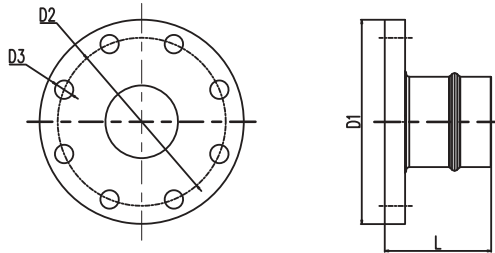

<b>AIRPIPE</b> Part No.	Diameter	Flange size	Bolt size	L	D1	D2	D3
2014 6170 00 30270060001	63	65	M16	85	185	145	18
2014 7170 00 30270070001	80	80	M16	82	200	160	18
2014 8170 00 30270080001	100	100	M16	92	220	180	18
2014 9170 00 30270100001	150	150	M20	100	285	240	22
2012 A170 00 30270110001	200	200	M20	109	340	295	22

\* 8 pieces of flange bolts(7cm) and 1 piece of flange gasket are attached.

## Aluminum Reduced Flange Connector

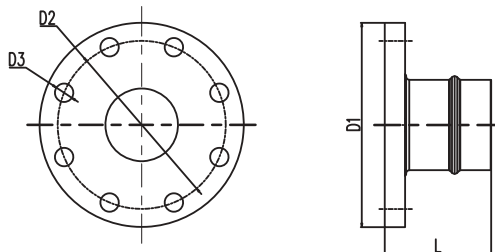

<b>AIRPIPE</b> Part No.	Diameter	Flange size	Bolt size	L	D1	D2	D3
2014 7671 00 30271070601	63	80	M16	85	200	160	18
2014 8671 00 30271080601	63	100	M16	87	220	180	18
2014 6771 00 30271060701	80	65	M16	87	185	118	18
2014 8771 00 30271080701	80	100	M16	84	220	180	18
2014 0771 00 30271090701	80	125	M16	84	250	210	18
2014 7871 00 30271070801	100	80	M16	92	200	160	18
2014 0871 00 30271090801	100	125	M16	92	250	210	18
2014 9871 00 30271100801	100	150	M20	92	285	240	22
2014 0971 00 30271091001	150	125	M16	100	250	210	18

\* 8 pieces of flange bolts(7cm) and 1 piece of flange gasket are attached.



## Flange with Female Thread

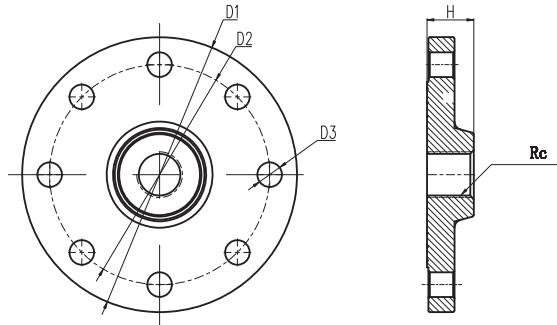

AIRPIPE Part No.	Diameter	Rc(Female thread)z	Bolt size	D1	D2	D3	H
2009 2270 00 30270020201	25	1"	M12	115	85	14	28
2016 3370 00 30270030301	32	1-¼"	M16	140	100	18	30
2009 4470 00 30270040401	40	1-½"	M16	150	110	18	32
2009 5570 00 30270050501	50	2"	M16	165	125	18	34
2009 6270 00 30270060201	65	1"	M16	185	145	18	32
2009 6470 00 30270060401	65	1-½"	M16	185	145	18	32
2009 6570 00 30270060501	65	2"	M16	185	145	18	32
2009 7270 00 30270070201	80	1"	M16	200	160	18	34
2009 7470 00 30270070401	80	1-½"	M16	200	160	18	34
2009 7570 00 30270070501	80	2"	M16	200	160	18	34
2009 7670 00 30270070601	80	2-½"	M16	220	180	18	34
2009 8470 00 30270080401	100	1-½"	M16	220	180	18	40
2009 8570 00 30270080501	100	2"	M16	220	180	18	40
2009 8670 00 30270080601	100	2-½"	M16	220	180	18	40
2009 9470 00 30270100401	150	1-½"	M20	285	240	22	44
2009 9570 00 30270100501	150	2"	M20	285	240	22	44
2009 9670 00 30270100601	150	2-½"	M20	285	240	22	44
2009 9770 00 30270100701	150	3"	M20	285	240	22	44

\* Above flange material: stainless steel.

\*1 piece of flange gasket and 4 pieces of flange bolts(7cm) are attached for DN25/DN40/DN50 /Dn63.

\*1 piece of flange gasket and 8 pieces of flange bolts(7cm) are attached for DN80/DN100/DN150



AIRPIPE Part No.	Diameter	Rc(Female thread)z	Bolt size	D1	D2	D3	H
2009 2279 00 30279020201	25	1"	M12	115	85	14	28
2016 3379 00 30279030301	32	1-¼"	M16	140	100	18	30
2009 4479 00 30279040401	40	1-½"	M16	150	110	18	32
2009 5579 00 30279050501	50	2"	M16	165	125	18	34
2009 6279 00 30279060201	65	1"	M16	185	145	18	32
2009 6479 00 30279060401	65	1-½"	M16	185	145	18	32
2009 6579 00 30279060501	65	2"	M16	185	145	18	32
2009 7279 00 30279070201	80	1"	M16	200	160	18	34
2009 7479 00 30279070401	80	1-½"	M16	200	160	18	34
2009 7579 00 30279070501	80	2"	M16	200	160	18	34
2009 7679 00 30279070601	80	2-½"	M16	220	180	18	34
2009 8479 00 30279080401	100	1-½"	M16	220	180	18	40
2009 8579 00 30279080501	100	2"	M16	220	180	18	40
2009 9279 00 30279100201	150	1"	M16	220	180	18	40
2009 9479 00 30279100401	150	1-½"	M20	285	240	22	44
2009 9579 00 30279100501	150	2"	M20	285	240	22	44
2009 9679 00 30279100601	150	2-½"	M20	285	240	22	44
2009 9779 00 30279100701	150	3"	M20	285	240	22	44

\* Above flange material: Carbon steel.

# Flexible HOSE

## Features

- Compressor outlets (absorption of vibration)
- To bypass obstacles and join to different levels.
- To admit the expansion and contraction of the aluminum pipe.
- Max. working pressure for the flexible hose used for compressed air: 15bar from -20°C~+70°C.
- Resistant to mineral and synthetic compressor oils.

## High pressure Hose



AIRPIPE Part No.	Diameter	Pipe length	Configuration
2009 1055 00 30255010001	20	1000	
2009 2055 00 30255020001	25	1000	
2016 3155 00 30255030101	32	1000	
2009 4055 00 30255040001	40	500	
2009 4155 00 30255040101	40	1200	With 2 fix clips 2009 4122 00; 2 supports 2009 0732 00
2009 5055 00 30255050001	50	500	
2009 5155 00 30255050101	50	1200	With 2 fix clips 2009 5122 00; 2 supports 2009 0732 00

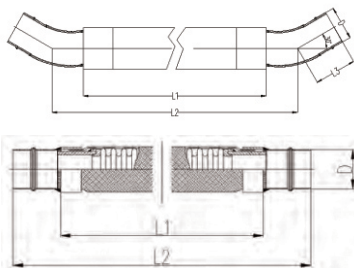
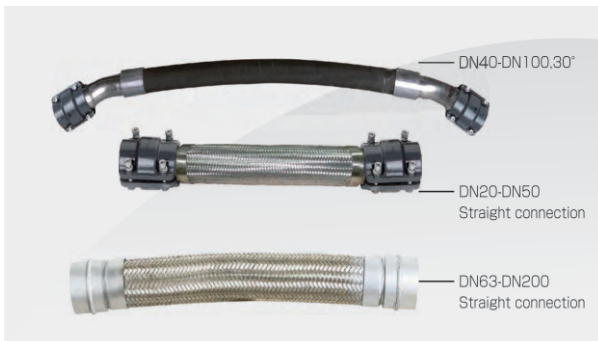

AIRPIPE Part No.	Nominal Diameter	D	L1	L2	Remark
AE17 1055 99 30255010004	20	20.1	19.69	22.44	SS304 material, 30°
AE17 2055 99 30255020004	25	25.1	19.69	22.44	
AE17 4055 99 30255040004	40	40.1	19.69	23.62	
AE17 5055 99 30255050004	50	50.1	19.69	23.62	
AE17 4155 99 30255040104	40	40.1	39.37	47.24	SS304 material, 30°
AE17 5155 99 30255050104	50	50.1	43.31	53.15	
2014 6155 00 30155060101	63	67.6	47.24	53.15	Rubber material, 30°
2014 7155 00 30155070101	80	84.8	66.93	72.83	
2014 8155 00 30155080101	100	101.8	66.93	74.80	
2016 6055 00 30155060001	63	67.6	19.69	25.59	SS304 material, Straight connection
2016 7055 00 30155070001	80	84.8	19.69	25.59	
2016 8055 00 30155080001	100	101.8	19.69	25.98	
2017 9055 00 30155100001	150	153	35.43	41.89	
2017 A055 00 30155110001	200	205	55.12	61.18	

\*Two pipe to pipe connectors are needed for the hoses (63mm-200mm)

\*Warranty 1 Year

# Fixture Accessories

## Features

- Suitable for various piping structure
- Used of installing pipes on well, roof or canals, vertically or horizontally
- Perfectly suitable for AIRPIPE SYSTEM

## Flexible pipe clip

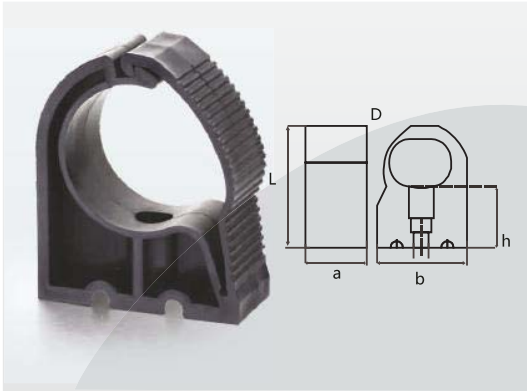

AIRPIPE Part No.	D	I	L	H	a	b
2009 1022 00 30222010001	20	M8	56	30	30	31
2009 2022 00 30222020001	25	M8	60	27.5	30	38
2016 3022 00 30222030001	32	M8	80	30	40	50
2009 4022 00 30222040001	40	M8	101	50	40	60
2009 5022 00 30222050001	50	M8	108	45	40	75
2014 6022 00 30222060001	67	M8	118	38.5	40	94
2014 7022 00 30222070001	84	M8	172	71	50	119
2009 8022 00 30222080001	100	M8	209	83	60	162

## Pipe Clip Gasket

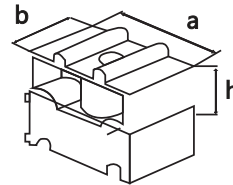

AIRPIPE Part No.	D	a	b
2009 0027 00 30227000101	20-25	30	49
2009 0127 00 30227000201	40-63	30	94

\*Keeping pipe elevation and levelness at the reducer pipe to pipe location.

## Fixing Clip/Clip



### Fixing Clip

AIRPIPE Part No.	D
2014 4122 00 30222040101	40
2014 5122 00 30222050101	50
2014 6122 00 30222060101	67
2014 7122 00 30222070101	84
2014 8122 00 30222080101	100

1.Used for fixing the two ends of high pressure hose, and 4 pieces of M10 screw nut are attached.  
2.Used outdoors (Anti-UV) and compressor room (high intensive).

### Clip

AIRPIPE Part No.	D
2014 9122 00 30222100101	150
2014 A122 00 30222110101	200

\*2009 2350 00 for concrete wall  
2009 2250/1250 00 for the steel frame  
2009 0665/1465/1565 00 for the bracket and grider clamp.

## Wall Mounted Bracket

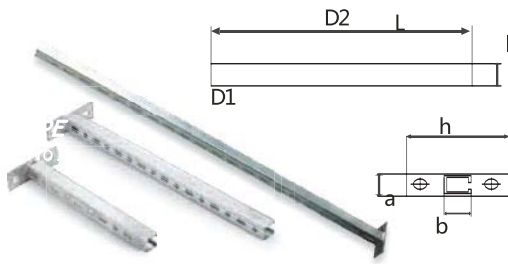

AIRPIPE Part No.	L	I	H	a	b
2009 0032 00 30132000001	300	27	120	40	30
2009 0132 00 30132000101	500	27	120	40	30
2009 0232 00 30132000201	1200	27	120	40	30

## Triangle Bracket

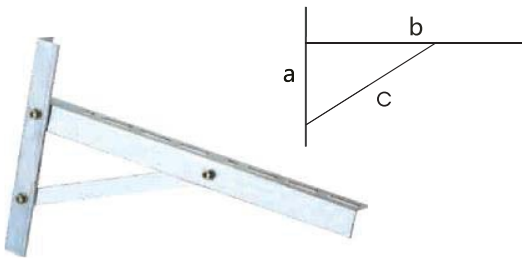

AIRPIPE Part No.	a	b	c
2012 0632 00 0132000601	300	500	310
2014 0732 00	300	500	310

\*Two iron expansions are attached. To support the line above DN150, DN200.

## Adjustable Bracket



AIRPIPE Part No.	L
2009 0432 00 30132000401	1200~2400
2017 0532 00 30132000501	1980

\*2009 0432 00 is used for fixing the threaded filter;

2009 0532 00 is used for fixing the flange filter.

\*Four iron expansion are attached.

## Square Steel

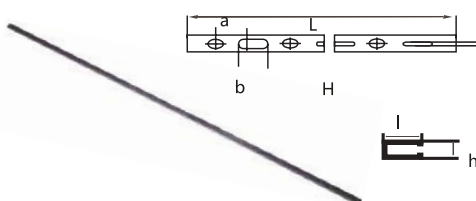

AIRPIPE Part No.	L	I	H	h	a	b
2009 0230 00 30133000101	300	306	27	11	24	20

\*When the square steel is fixed to the concrete pile, the iron expansion 2009 1650 00 is needed.

\*Two iron expansion are attached.

## Fastener



AIRPIPE Part No.	D	I	a	b
2009 0037 00 30133000201	70	43	20	4

## Knot Tie

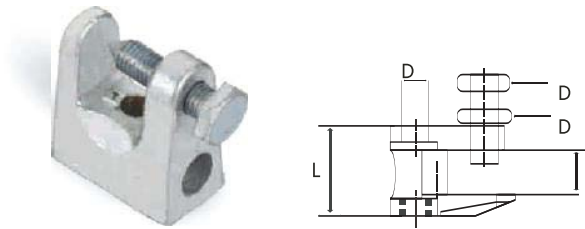

AIRPIPE Part No.	D	L	I
2009 0433 00 30133000301	M8	36	18

## T bolts



AIRPIPE Part No.	D	L
2009 0665 00 30133000401	M8	50
2009 1465 00 30133000402	M8	60
2009 1565 00 30133000403	M8	70

\*The washers are attached.

## Threaded Steel Rod



AIRPIPE Part No.	D	L	Remark
2009 1150 00 30133000601	M8	40	Connecting buckle
2009 1750 00 30133000501	M8	3000	Connecting rod

\*Two 8mm screws are attached.



## Inner Hexagon Iron Expansion



AIRPIPE Part No.	D
2012 3750 00 30133000704	12cm

\*2012 3750 00 is used for fixing the threaded steel rod to the wall.

## Iron Expansion



AIRPIPE Part No.	D
2009 1550 00 30133000702	M8
2009 1650 00 30133000703	M10

\* Used for fixing the wall mounted bracket.

## Drilling Tail Screw and Plastic Expansion Screw



AIRPIPE Part No.	D	Remark
2009 1250 00 30133000802	M5.5x60	Drilling Tail Screw
2009 2250 00 30133000801	M5.5x35	Drilling Tail Screw
2009 2350 00 30133000901	M6x60	Plastic Drilling Tail Screw

## Wire Rope



AIRPIPE Part No.	D
2009 0150 00 30133001002	12

One piece of wire rope shall be requiring 4 wire rope clamp and 2 wire rope knot tie.

## Wire Rope turnbuckle



AIRPIPE Part No.	D
2009 0850 00 30133001102	12

## Wire Rope Clamp



AIRPIPE Part No.	D
2009 0250 00 30133001202	12

## Universal Clamp



AIRPIPE Part No.	D
2009 0135 00 30133001301	25
2009 0235 00 30133001302	50

## Beam Suspender



AIRPIPE Part No.	L	H	D1	D2
2009 0335 00 30133001401	50	25	M6	M8

# Tool

## Tool Box



AIRPIPE Part No.	H	L	I
2009 0045 00 30145000101	460	330	140

- Spanner 2009 1228 00X1,2012 4228 00X2 ,2012 5228 00X2
- Water pump plier 2009 0028 00
- Hole deburrer 2009 0042 00
- Aluminum pipe cutter 2009 0040 00
- Aluminum pipe deburrer 2009 0141 00
- Drill holder 2009 0243 00x2
- Drill 2009 0043 00,2009 0143 00
- Marker 2009 0044 00
- L Key 6mm ,8mm
- One Marking Pen
- Tool Bag

AIRPIPE Part No.	DESCRIPTION
2009 0240 00 30135000204	DN6-63 Cutter Blade
2009 0340 00 30135000205	DN-63-100 Cutter Blade

## Pipe Cutter Blade



## Sample Box

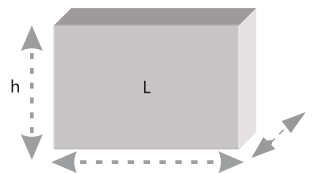

AIRPIPE Part No.	H	L	I
AE 15 0146 00 30246000101	200	270	190

Note: About Component of Sample Box, Asking for company Please.

## Pipe Cutting Machine



AIRPIPE Part No.	Applicable diameter
2015 0344 00 30135000101	DN63~DN200

## Aluminum Pipe Cutter



AIRPIPE Part No.	L	H	Applicable diameter
2009 0040 00 30135000201	220	40	DN6~ DN63
2009 0140 00 30135000203	240	40	DN40~DN110

## Aluminum pipe deburrer



AIRPIPE Part No.	L	H	Applicable diameter
2009 0141 00 30135000301	90	70	DN12~DN57

## Drill Holder    Drill Tool



## Hole Deburrer



AIRPIPE Part No.		L	Applicable diameter
2009 0042 00	30135000401	160	All Diameter

Sizing Chart for Quick Drops

Drill	Drill Holder	DN (MM)	Quick Drops (PN)						
2009 0243 00	2009 0043 00	Φ14	2015 2110 99	2015 2011 99	AE15 2110 99				
2009 0243 00	2018 0743 00	Φ16	AE18 2110 99	AE18 2210 99	2018 2011 00				
2009 0243 00	2009 0143 00	Φ19	2015 4110 99	2015 4210 99	2015 4011 00	2015 4111 00	2015 5110 99	2015 5210 99	
			2015 5011 99	2015 5111 99	2015 6110 99	2015 6210 99	2015 6011 00	2015 6111 00	
			2015 7110 99	2015 7210 99	2015 7011 00	2015 7111 00	2015 A210 99	AE15 6110 99	AE15 6210 99
			AE15 4110 99	AE15 4210 99	AE15 5110 99	AE15 5210 99			
			AE15 7110 99	AE15 7210 99	AE15 A210 99				
2009 0243 00	2018 0843 00	Φ22	AE18 4110 99	AE18 4210 99	2018 4011 00	2018 4111 00			
2009 0243 00	2009 0343 00	Φ25	2015 8110 99	2015 8210 99	2015 8011 00	2015 9110 00	2015 9210 99	2015 9011 99	
			AE17 8110 99	AE17 8210 99	AE17 9110 99	AE17 9210 99	AE17 8110 99	AE15 8210 99	
			AE17 6110 99	AE17 6210 99	2017 6011 00	2017 6111 00	AE15 9110 99	AE15 9210 99	
			AE17 7110 99	AE17 7210 99	2017 7011 00	2017 7111 00			
			AE17 5110 99	AE17 5210 99	2017 5011 00	2017 5111 00			
2015 0643 00	2015 0443 00	Φ38	2015 8410 99	AE15 8410 99					
	2015 0543 00	Φ51	2015 9410 99	2015 9510 99	2015 A410 99	2015 A510 99			
			AE15 9410 99	AE15 9510 99	AE15 A410 99	AE15 A510 99			

\*before drilling, mount the quick drop reversely and mark  
.Drill to the reverse side of the quick drip at the speed of 650r/m. After drill ,remove the burr and clean up.

## Pipe Bender



AIRPIPE Part No.		L	Applicable diameter
2016 0047 00	30147000101		DN20
2016 0147 00	30147000201		DN25

## Water pump plier



AIRPIPE Part No.		Applicable diameter
2017 0028 00	30135000701	DN25~DN180

## Marker



AIRPIPE Part No.		L	Applicable diameter
2014 0044 00	12044000501	220	DN25~DN100

## Pipe Lugging Machine

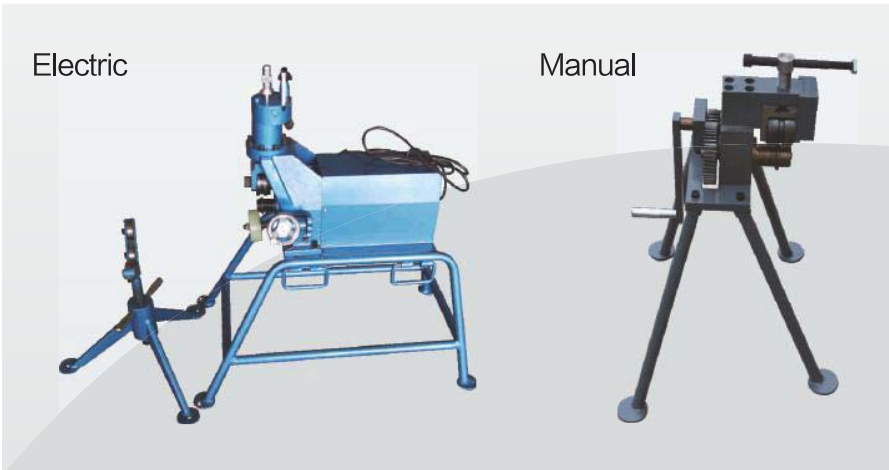

AIRPIPE Part No.		Normal Diameter	L
2009 0144 00	30144000201	DN63~DN200	Electric
2014 0544 00	30144000101	DN63~DN200	Manual

## Hand-hold lugging machine with charge way



AIRPIPE Part No.	Applicable diameter	Drive method
AE15 0844 00	DN63~DN200	Hydraulic
2017 1844 00	DN63~DN200	Jaws of Hydraulic Machine

## Magnetic Drill



AIRPIPE Part No.	Application	Fixing Method
2014 0644 00	used in drilling in steel structure.	fixing with magnetic force

# Important installation guide

---

## Installation Instruction

---

### AIRPIPE pipes and hoses

AIRPIPE pipes should be protected from mechanical shock, particularly if exposed to collision with fork-lift or when positioned in an environment with moving loads overhead. Meanwhile, rotation of the pipe and pipe supports should be avoided. The pipeline system can not be connected by welding. Regarding the AIRPIPE hose, please use as per the installation guidelines.

### General

Prior to the installation of an AIRPIPE compressed air distribution system, the installer should ensure that the installation area complies with any regulations applicable to explosion hazardous (in particular the effect of static in well and warehouse). AIRPIPE should be installed downstream of the compressed air receiver or after the dryer. AIRPIPE hose can be installed at the very start of the system in order to eliminate any sources of vibration and facilitate maintenance and operations. Before repair or modify the AIRPIPE system, the relevant section should be pressure relieved and emptied. Installers should only use the AIRPIPE components and accessories, AIRPIPE pipe clips and fixture clamps in particular. The technical properties of the AIRPIPE components must be complied with what is described in the AIRPIPE catalogue.

### Component assembly

AIRPIPE components are provided with assembly instructions for their correct use--simply follow the methods and recommendations stated in this document.

### Commissioning the installation

Once the AIRPIPE installation has been installed and prior to the commissioning, the installer should complete all the test, inspection and compliance check as stated in the contract and according to reasonable engineering practice and current local regulations.

### Expansion/Contraction

Expansion and contraction of the system can be automatically met with the correct installation. The designer and installer should calculate the elongation and shrinkage of each pipeline according to this installation guideline.

### Situations to be avoided

Installation within a solid mass (concrete, foam, etc.). Especially underground. Exposure to chemicals those are incompatible with AIRPIPE components. Use AIRPIPE for earthing, or as a support for the electrical equipment. The hanging of any external device to AIRPIPE.

### AIRPIPE meets all the above requirements

---

## Reasonable engineering practice for the optimization of an air pipe work system

---

- The work should be performed in accordance with the reasonable engineering practice in the process of installation.
  - Bends cause the pressure drop.
  - To avoid big pressure loss, use the hose or modular to offset the network for the purpose of bypassing the obstacles. Minimize the pipe diameter reduction.
- 
- Keep a good quality of clean air with adequate filtration at the compressor outlet.
  - The diameter of the pipe will influence the pressure drop and the operation the point-of-use equipment. Select the diameter according to the required flow rate and the acceptable pressure drop at the point of use. Never round the pipe system in order to facilitate maintenance or service.



## AIRPIPE Aluminum Pipe

### General

- AIRPIPE aluminum pipe is supplied ready for use. No preparation is needed.
- Thanks to the rigidity of AIRPIPE aluminum pipe, the expansion and contraction, related temperature, are reduced to the minimum. As time goes by, the AIRPIPE network retains its straightness and hence its performance.
- Aluminum pipe is verified and fitted perfectly with its fittings. Each connection is automatically secured and the seal is optimized. The use of this pipe minimizes corrosion to the internal surface (self-protection of the pipe by the formation of alumina oxide).
- AIRPIPE aluminum pipe is available in 9 diameters: DN20, Dn25, DN32, DN40, DN63, DN80, DN100, DN150, DN200.
- AIRPIPE aluminum pipe from DN20-DN200 is especially designed for the primary and secondary network system for compressed air, vacuum and inert gas(nitrogen, argon).

### Identification

This identification can be done by sticking the adhesive labels directly to the pipe.

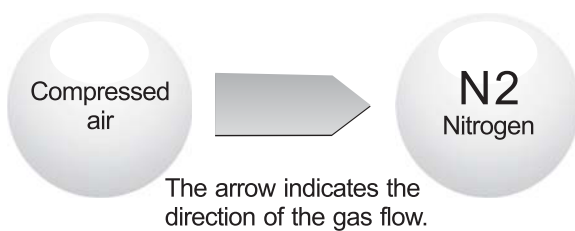

### Connection Indicator

Prior to the installation, the different size of aluminum pipe (DN20 -DN50) need to be marked connection indicator on the surface of the pipe by special marker pen as a reference during connection.

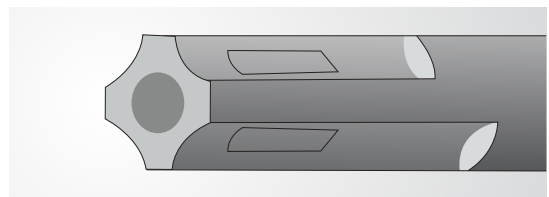

### Drilling Indicator

There is one locators on each pipe. They can ensure the correct position during drilling more holes on the pipe.

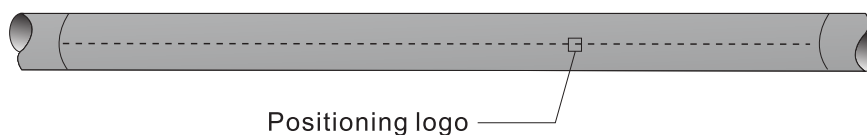

## Fixing and supporting for AIRPIPE network



Iron expansion is needed when fixing the tube clip on the wall. All AIRPIPE tube clip are fixed with 8mm screw.

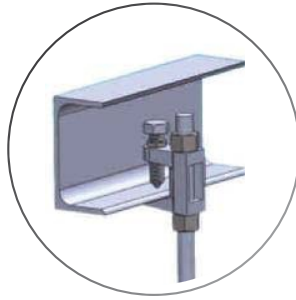

For small diameter (DN20-DN80), girder clamp (2009 0433 00) is used for the steel beam

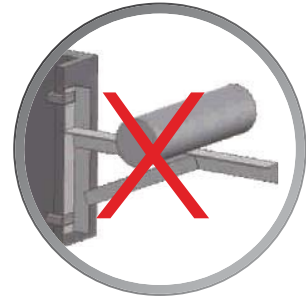

For large diameter (DN100-DN200), girder clamp can not be used for the steel beam (Insufficient Rigidity)

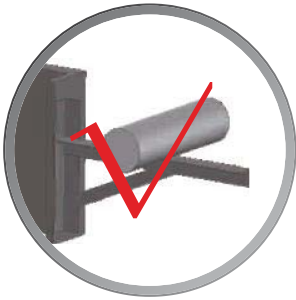

For large diameter (DN100-DN200), welding could be used for the steel beam.

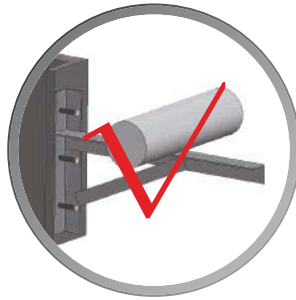

For large diameter (DN100-DN200), drilling could be used for the steel beam.



The cantilever bracket (2009 0032 00 and 2009 0132 00, the length of cantilever: 30 and 50cm) can be used when installation position is further away from the wall.

## Cutting The Pipe

Rotate the corresponding pipe cutter around the pipe while gently tightening the wheel.



using the cutter 2009 0040 00 for DN20-DN63  
 using the cutter 2009 0140 00 for DN 40-DN100  
 using the cutter 2009 0240 00 for DN 63-DN200

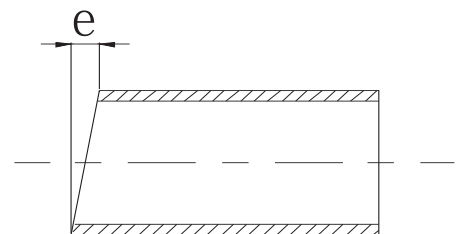

Normal Diameter	Cutting slope of pipe end allowable deviation (e)
20-80	1.0
100-150	1.4
200	2.0

## Deburring

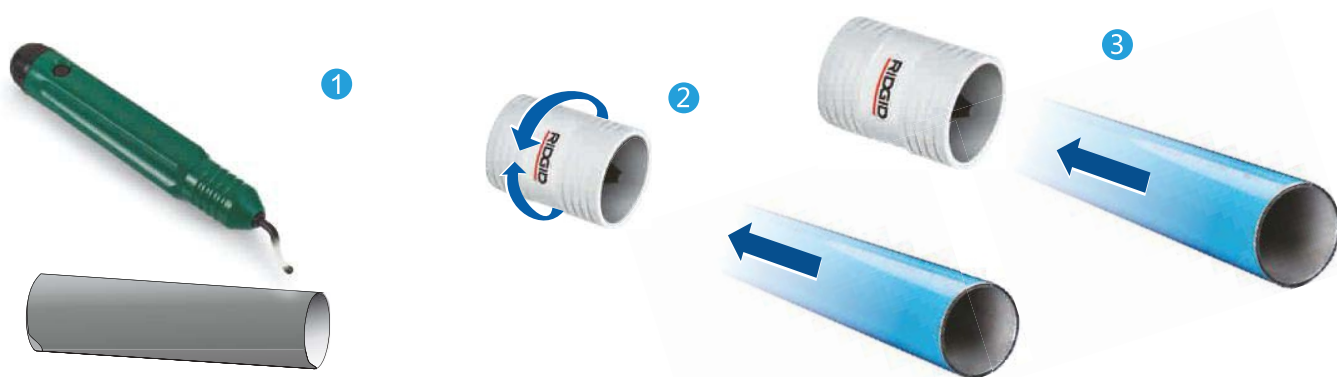

Deburr and remove any swarf with a deburring tool (209 0042 00) and a file for diameter between DN63 to DN200.

Deburr with a deburring tool 209 0141 00 for DN20-DN50

## Seal Kit

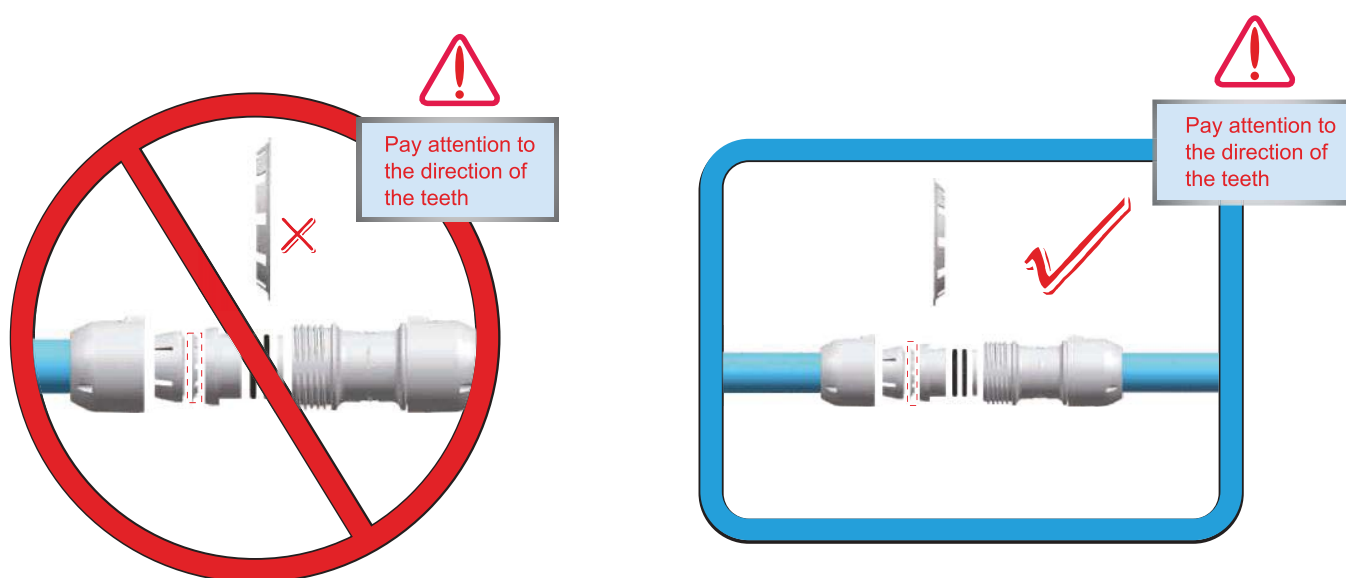

# Pipe To Pipe Connectors

DN20-DN50

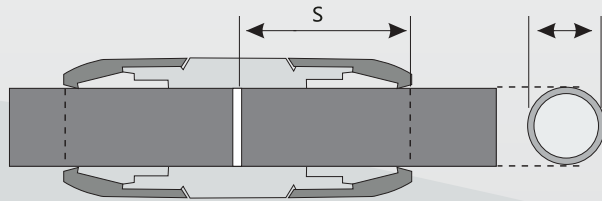

## Suitable For All Connectors Installation

2009 0044 00

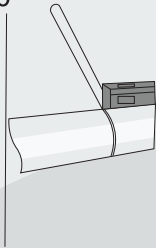

Mark the pipe at the desired position with a marker pen(2009 0044 00)



Loosen the screw thread of the pipe to pipe connect and then insert pipe.

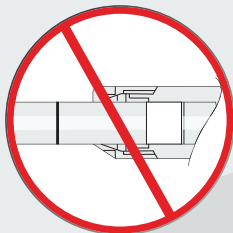

Make sure that the pipe position meets the requirement of AIRPIPE

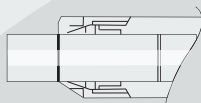

To prevent screw nut loosening, screw should be used to reinforce it.

**A** Tightening the pipe by hand for DN20-DN50  
Ø20-32 mm

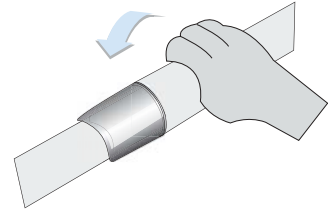

**B** Tightening the pipe with a spanner for DN40-DN100  
Ø40 mm/1 1/2  
Ø50 mm/2"

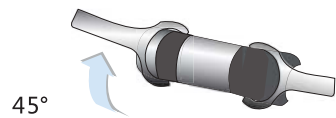

\*Please be noted that there are two types of DN40/DN50 spanner. Please use 2009 4028 00 for the polymer connector while using 2009 5028 00 for the aluminum connector.

Diameter	S size(mm)	Diameter	S size(mm)
DN20	49	DN40	69
DN25	52	DN50	75
DN32	60		

The size S is the length inserting the pipe into the connector. It should be ensured during installation.



# DN63–DN200

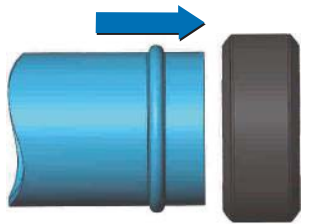

Slip the sealing element over the end of the first pipe fully up to the shoulder of lug.

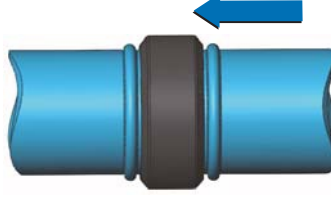

Bring the second pipe to seal element and slide fully up to the shoulder.

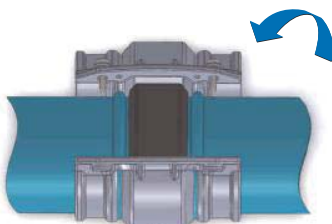

Position the clamp over the sealing element.

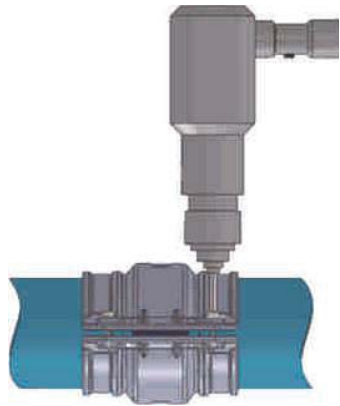

Fully tighten the clamp screws.  
Minimum Tighten Torque:10Nm. Maximum Tighten Torque:44.5Nm,makes the clamp closed fully.

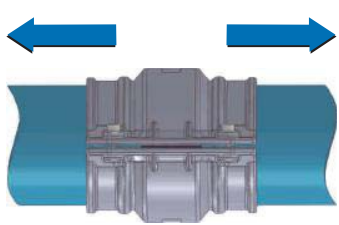

Pull the pipe fully back towards the outside of the clamp.

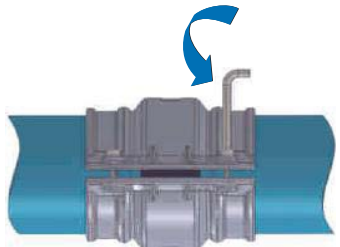

Tighten the pre-fitted screws with a screwdriver at first.

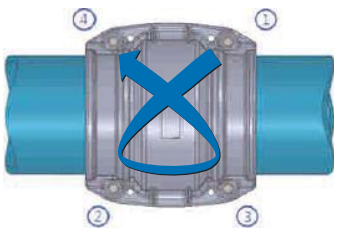

For effective clamp sealing, screw tightening should be performed on alternate sides of the clamp. To disconnect , perform the same operation in reverse order.

## Hand-held hydraulic lugging machine operation requirements

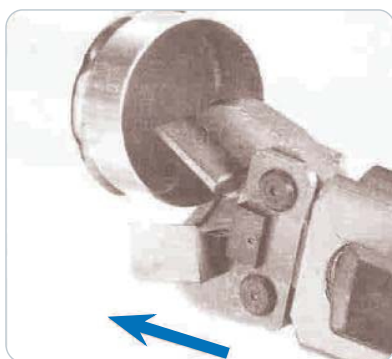

Manually open the jaws of the clamp and insert the aluminum pipe into the clamp as far as possible.

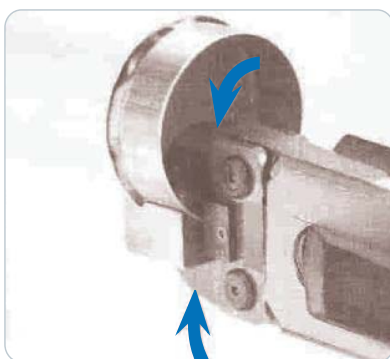

Release the jaws. Press the trigger and crimp the pipe until a "snap" sound is heard.

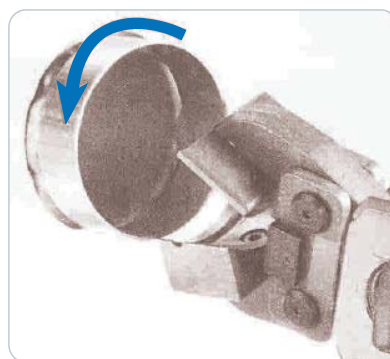

Re-open the two jaws to remove the pipe and rotate the pipe slightly.

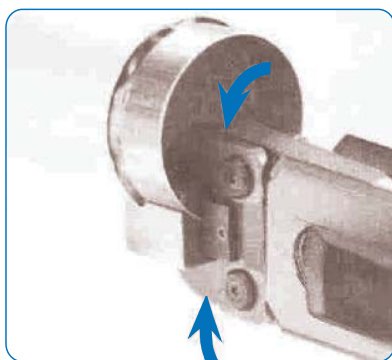

Renew the operation until the required minimum number of lugs for each diameter is finished.

## Hand-held hydraulic lugging machine operation requirements

AIRPIPE	DN63	DN80	DN100	DN150	DN200
Min. number of lugs	5	6	6	9	12

Note: Do not overlap the lugs!

## Lugs size for DN63~DN200

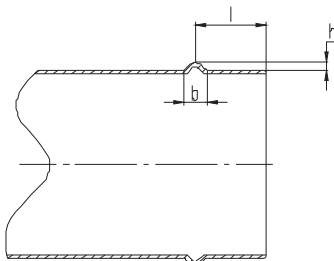

Normal Diameter	Basic Size		
	b	h ± 0.3	l
63	9.9	2.6~3.2	34.5
80	9.9	2.6~3.2	34.5
100	9.9	2.6~3.2	34.5
150	9.9	3.0~3.3	34.5
200	10	3.0~3.3	34.5

## Flowmeter installation instruction:

Pipe type before sensor	Straight pipe length	Pipe type before sensor	Straight pipe length
Concentric contraction fully open valve	15DN 5DN	one 90° Elbow	20DN 5DN
The same plane two 90° elbow	25DN 5DN	Different plane two 90° Elbow	40DN 5DN
Concentric expansion pipe	30DN 5DN	Control valve half open (Not recommend)	50DN 5DN

## Pipe Clip

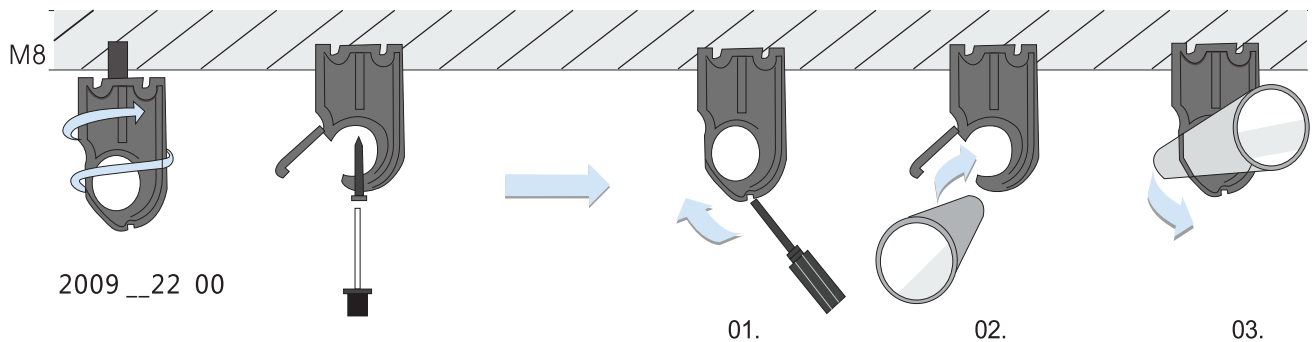

The fixing clip in AIRPIPE system is especially designed for AIRPIPE aluminum pipe. It can be used conveniently and adapts to expansion and contraction of AIRPIPE aluminum pipe so that it can ensure the system safety. The bolt size 8mm is suitable for all fixing clip.

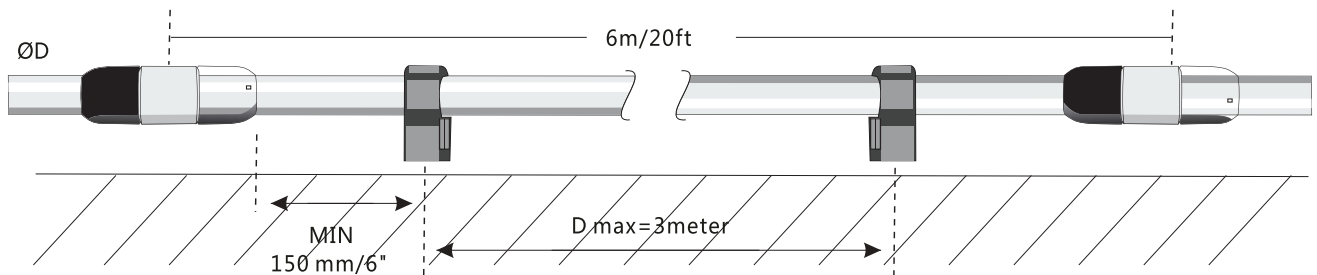

The fixing clips should be fitted at a distance of at least 150mm from a quick assembly bracket in order to allow for the expansion and contraction of aluminum pipe.

Ø	L(m)	D size(m)
20-25	6	3
40-50	6	4
63-200	6	5

## Gasket For Pipe Clip

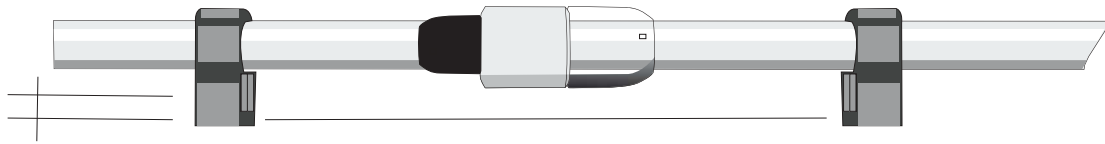

2009 0027 00  
Ø20-25 mm/ $\frac{3}{4}$ "-1"

2009 0127 00  
Ø40-63 mm/ $1\frac{1}{2}$ "-2 $\frac{1}{2}$ "

The gasket can make different diameter pipe installed in one line. Also it can be conveniently connected to different branch pipe from main pipe.

## Loop Piping Close

DN25-DN80 ( Use Hose )



The quick connection mode for DN100/DN200 can be used conveniently in the close of the looping ring

Please consult us more for the usage instruction of the hose.

## Installing Quick Drop Connectors

01



- Mark the pipe where the hole for the quick drop connector will be installed.

02



- Identify the drill arbor & hole saw bit required by locating the quick drop part number on the sizing chart.  
Note: the quick drop part number is located on the connector.

03



- With the proper drill arbor & hole saw bit part numbers identified, thread the hole saw bit onto the drill arbor to create a single drill bit.

04



- Hold the drill perpendicular to the pipe with the drill bit in the center of the mark placed on the pipe.



05

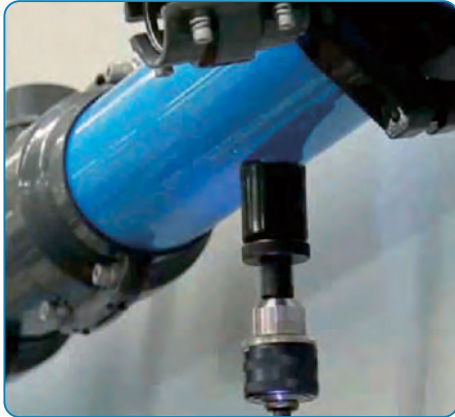

- Apply steady pressure until the hole saw bit has completely entered the pipe.

06

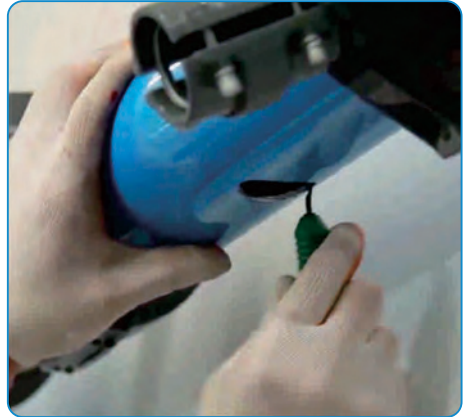

- Remove debris and deburr cut edges.

07



- The quick drop connector easily aligns into the drilled hole.

08



- Tighten the bolt to complete assembly

## Compensation the effects of expansion or contraction due to variations in temperature

1) In order to compensate the effects of expansion or contraction due to variations in temperature, any fluctuations in the length of the AIRPIPE aluminum pipe network should be calculated.

2) .Expansion length per °C for one meter of AIRPIPE aluminum pipe is: 0.024mm

C= coefficient of expansion; L=straight length (meter; between the two fixed points);

ΔT=temperature variation between the installation temperature and the operation temperature(°C);

DL=Total expansion  $DL=C \times L \times \Delta T$

Consequences of the pipeline expansion or contraction caused by temperature variations:

2.1) The stress concentration of the pipe to pipe joints and elbows may cause air leakage or explosion even worse.

2.2) Obstacles

2.3) The drop lines may be endangered.

Eg: the diameter of the pipe is DN 63, and the length is 100m, the installation temperature is 15 degree, and the operating temperature is 45 degree  $DL=0.024 \times 100 \times (45-15)=72\text{mm}$

1	▲ T	6 m		Allowable max. installation distance ( meters )								
		D	L	DN20	DN25	DN32	DN40	DN50	DN63	DN80	DN100	DN150
2	20°C	2.88mm	The pipe can prolong itself	The pipe can prolong itself	120	120	120	115	115	95	80	75
3	25°C	3.60mm			115	115	115	110	110	90	75	70
4	30°C	4.32mm			111	111	110	100	100	85	70	65
5	35°C	5.04mm			100	100	100	90	90	80	65	60
6	40°C	5.76mm			90	90	90	85	85	75	60	55

# Compensation the effects of expansion or contraction

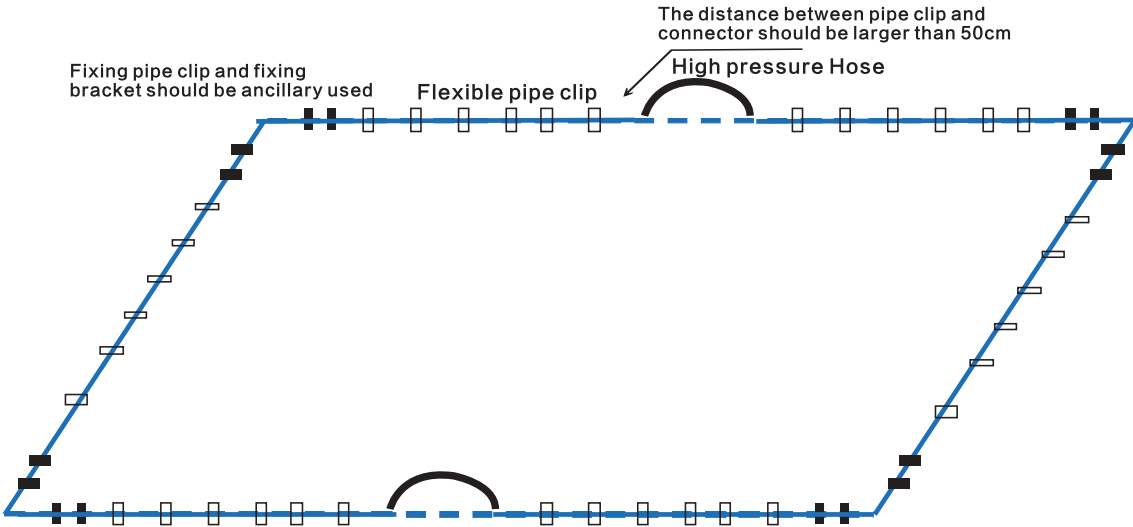

Compensation the effects of expansion or contraction for DN20-DN100

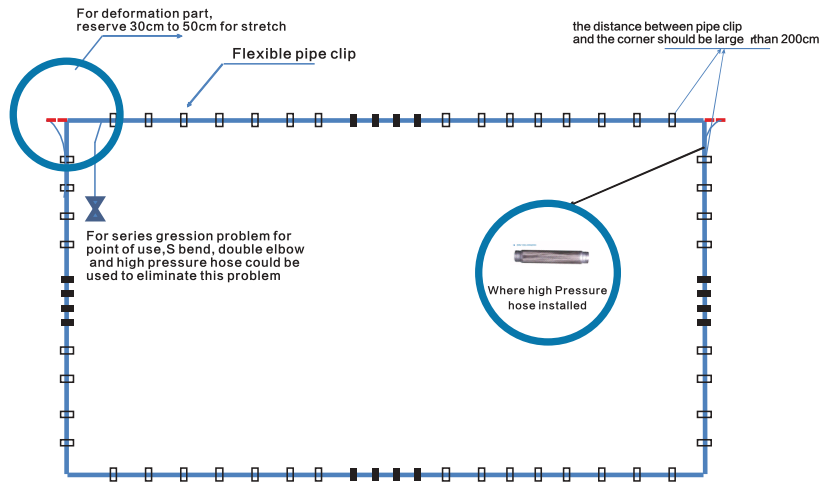

Compensation the effects of expansion or contraction for DN63-DN200

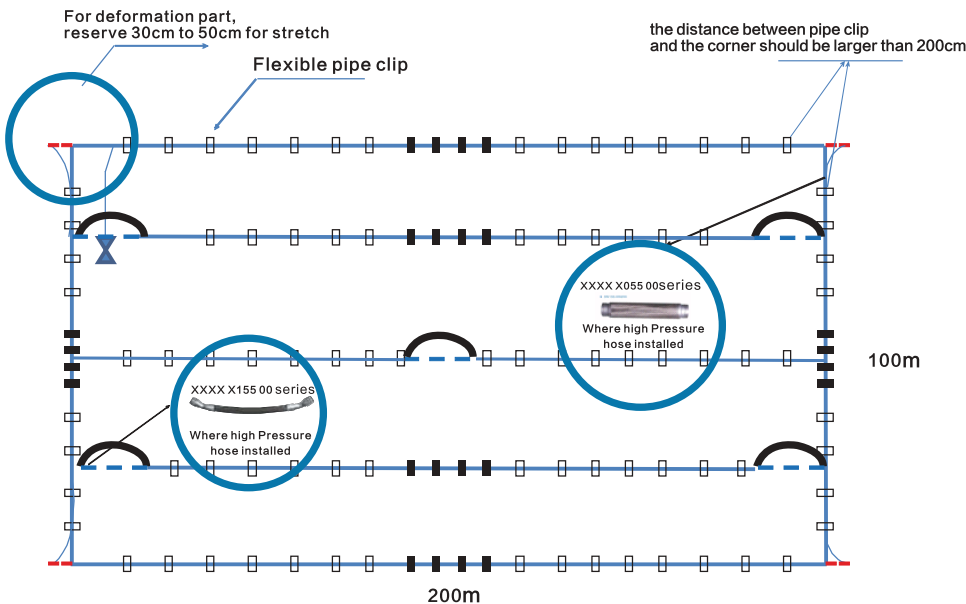

# Pneumatic Accessories



\*Warranty 1 year

## Pressure Meter



AIRPIPE Part No.	D	Remark
2009 0483 00 30134000101	½"Male thread	Shock resistance ,0–1.6MPa,1.6 degree, the shock absorbing pipe is attached.
2009 0583 00 30134000102	½"Male thread	Non-Shock resistance, 0–1.6MPa,1.6 degree, 。
2009 0683 00 30134000103		1/2" Female thread-1/2" Male thread, Brass shock absorbing .

## Automatic Drain Valve



AIRPIPE Part No.	Inlet size	PN
2009 0973 00 30134000201	½" Female thread	16Bar

\*One ball valve is needed before using this drain valve.

## Electronic Drain Valve



AIRPIPE Part No.	Inlet size	PN
2009 0873 00 30134000301	½"	16Bar

\*One ball valve is needed before using this drain valve.

## Atmolysis Bag



AIRPIPE Part No.	L	D1	D2	D3
2016 1085 00 30185000101	200	¾"Male Thread	½"Male Thread	½"Female Thread
2016 2085 00 30185000201	300	¾"Male Thread	½"Male Thread	½"Female Thread
2016 3085 00 30185000301	400	¾"Male Thread	½"Male Thread	½"Female Thread

## Pneumatic Fittings



AIRPIPE Part No.	D	Connection Port
40SMT 60103000005	½" Male Thread	One-way connection
SMVA-P 60103000019	½" Male Thread	Two-way connection
SMYA-P 60103000022	½"Female Thread	Three-way connection
SMMA-P 60103000025	½"Female Thread	Four-way connection

## PU HOSE



PART NO.	I.D(mm)	O.D(mm)	LENGTH	TEMPERATURE	WORKING PRESSURE
IAP HUS2504	2.5	4	200M	-20°C ~ 60°C (-5°F ~ +140°F)	150PSI (1MPa)
IAP HUS0406	4	6	200M		
IAP HUS0508	5	8	100M		
IAP HUS6510	6.5	10	100M		
IAP HUS0812	8	12	100M		
IAP HUS1014	10	14	50M		
IAP HUS1216	12	16	50M		
IAP HUS651095135	9.5	13.5	50M		

## PU RECOILED AIR TUBE



PART NO.	I.D(mm)	O.D(mm)	LENGTH	TEMPERATURE	WORKING PRESSURE
IAP HUB0508	5	8	9/12/15	-20°C ~ 60°C (-5°F ~ +140°F)	200PSI
IAP HUB6510	6.5	10			200PSI
IAP HUB0812	8	12			200PSI
IAP HUB95135	9	13.5			200PSI
IAP HUB1014	10	14			200PSI
IAP HUB1216	12	16			200PSI



## AIR HOSE REEL



PART NO.	HOSE SIZE (mm)	LENGTH (M)	HOSE COLOR	HOSE
IAP HR01050810U	5X8	10	BLUE	PU Braid Hose
IAP HR01050812U	5X8	12	BLUE	PU Braid Hose
IAP HR01651010U	6.5X10	10	BLUE	PU Braid Hose
IAP HR01081208U	8X12	8	BLUE	PU Braid Hose



PART NO.	HOSE SIZE (mm)	LENGTH (M)	HOSE COLOR	HOSE
IAP HR0608 1230U-BD	8X12mm	30	BLUE	PU Braid Hose
IAP HR0665 1030U-BD	6.5X10mm	30	BLUE	PU Braid Hose

## AIR GUNS



B-90

B-91

B-93

### ► Specification

PART NO.	PORT SIZE	NOZZLE LENGTH	NOZZLE OD	MAX. PRESSURE	AIR FLOW
IAP B90	1/4" G	5CM	Φ 8mm	15Bar (213psi/1.5Mpa)	1200L/M @150psi
IAP B91		25CM			
IAP B93		12CM			

### ► Features

- 1 Steel reinforced inlet.
- 2 Light weight and durable.
- 3 High flow: flow higher than standard>1200L/M@150PSI.
- 4 Long life time: top-down valve structure design, less wear of spring, longer lifetime.

# AIR GUNS



Part Number	Filtor, Regulator & Lubricator
FRL 502 - G	TWO SECTION AIR UNIT 1/4" G
FRL 503 - G	TWO SECTION AIR UNIT 3/8" G
FRL 504 - G	TWO SECTION AIR UNIT 1/2" G
FRL 908 - G	TWO SECTION AIR UNIT 1" G



Part Number	Filtor & Regulator
FR 502 - G	TWO SECTION AIR UNIT 1/4" G
FR 503 - G	TWO SECTION AIR UNIT 3/8" G
FR 504 - G	TWO SECTION AIR UNIT 1/2" G
FR 908 - G	TWO SECTION AIR UNIT 1" G

## Coupler

### SM Socket Male : CS - Carbon Steel

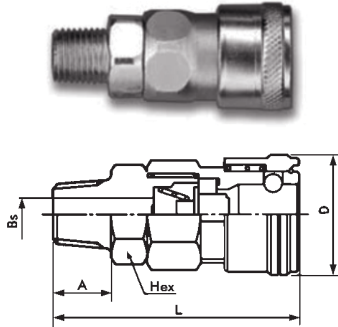

PART NO SS	L (mm)	D (mm)	Hex (mm)	A (mm)	Bs (mm)
IAP20SM CS	Rc1/4"	55.5	Hex.19	13.0	7
IAP30SM CS	Rc3/8"	56.5	Hex.19	14.0	8
IAP40SM CS	Rc1/2"	59.5	Hex.24	16.0	9
IAP600SM CS	Rc3/4"	67.0	Hex.32	19.0	16
IAP800SM CS	Rc1"	72.0	Hex.36	22.0	16

### PM Plug Male : CS - Carbon Steel

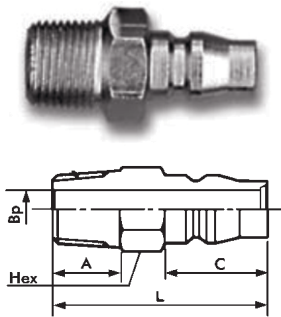

PART NO CS	APPLICATION	L (mm)	A (mm)	Hex (mm)	C (mm)	Bp (mm)
IAP20PM CS	Rc1/4"	41.0	13	Hex.14	20	7.5
IAP30PM CS	Rc3/8"	42.0	14	Hex.19	20	7.5
IAP40PM CS	Rc1/2"	46.0	16	Hex.22	20	12.0
IAP600PM CS	Rc3/4"	55.0	18	Hex.32	23	19.0
IAP800PM CS	Rc1"	63.0	22	Hex.35	23	22.0

### SF Socket Female : CS - Carbon Steel

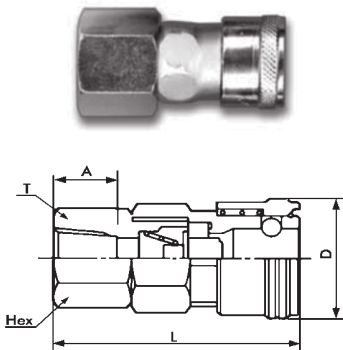

PART NO CS	APPLICATION	L (mm)	D (mm)	Hex (mm)	A (mm)	T
IAP20SF CS	Rc1/4"	49.5	26.5	Hex.19	13.0	Rc1/4"
IAP30SF CS	Rc3/8"	50.5	26.5	Hex.21	14.0	Rc3/8"
IAP40SF CS	Rc1/2"	52.5	26.5	Hex.29	15.0	Rc1/2"
IAP600SF CS	Rc3/4"	61.0	35.0	Hex.35	17.0	Rc3/4"
IAP800SF CS	R1"	68.0	35.0	Hex.41	22.0	Rc1"

### PF Plug Female : CS - Carbon Steel

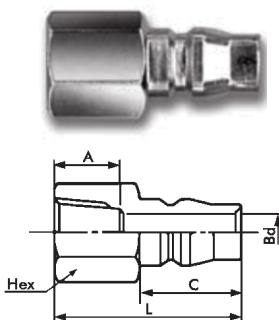

PART NO CS	APPLICATION	L (mm)	A (mm)	Hex (mm)	C (mm)	Bd (mm)
IAP20PF CS	R1/4"	36.0	13	Hex.17	20	7.5
IAP30PF CS	R3/8"	37.0	14	Hex.21	20	7.5
IAP40PF CS	R1/2"	38.0	15	Hex.29	20	7.5
IAP600PF CS	R3/4"	45.0	17	Hex.35	23	13.0
IAP800PF CS	R1"	54.0	22	Hex.41	23	13.0

**SH** Socket Hose : CS - Carbon Steel

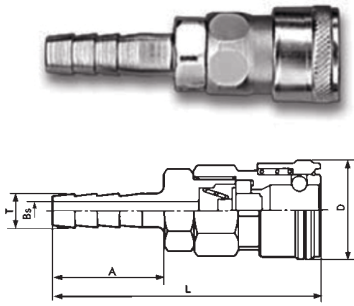

PART NO CS	APPLICATION	L (mm)	D (mm)	A (mm)	T (mm)	Bs (mm)
IAP20SH CS	For 1/4" Hose	72.5	26.5	30	9.0	5.0
IAP30SH CS	For 3/8" Hose	76.5	26.5	34	11.3	7.5
IAP40SH CS	For 1/2" Hose	78.5	26.5	36	15.0	9.0
IAP600SH CS	For 3/4" Hose	92.0	35.0	45	21.0	14
IAP800SH CS	For 1" Hose	102.0	35.0	55	27.0	16

**PH** Plug Hose : CS - Carbon Steel

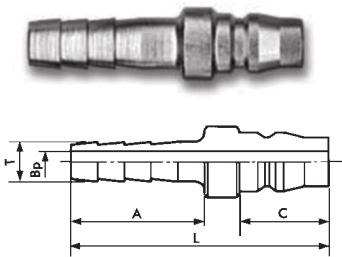

PART NO CS	APPLICATION	L (mm)	A (mm)	C (mm)	T (mm)	Bp (mm)
IAP20PH CS	For 1/4" Hose	57.0	30	20	9.0	5.0
IAP30PH CS	For 3/8" Hose	61.0	34	20	11.3	7.5
IAP40PH CS	For 1/2" Hose	63.0	36	20	15.0	7.5
IAP600PH CS	For 3/4" Hose	77.0	45	23	21.0	13.0
IAP800PH CS	For 1" Hose	85.0	54	23	27.0	20.0

**SN** Nut Socket : CS - Carbon Steel **Chrome Plated**

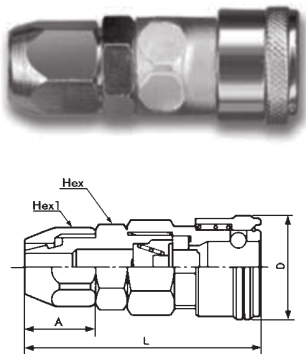

PART NO CS	APPLICATION	L (mm)	A (mm)	D (mm)	Hex (mm)	Hex1 (mm)
IAP50SN CS	8X5.5 Hose	60.0	17	26.5	Hex. 19	Hex. 19
IAP65SN CS	10X6.5 Hose	59.5	17	26.5	Hex. 19	Hex. 19
IAP80SN CS	12X8 Hose	61.5	19	26.5	Hex. 19	Hex. 19
IAP110SN CS	16X12 Hose	64.5	23	26.5	Hex. 23	Hex. 23
IAP100SN CS	14X10 Hose					

**PN** Nut Plug : CS - Carbon Steel **Chrome Plated**

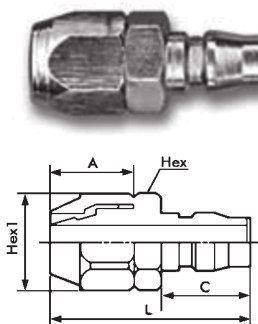

PART NO CS	APPLICATION	L (mm)	A (mm)	C (mm)	Hex (mm)	Hex1 (mm)
IAP50PN CS	8X5.5 Hose	43.0	17	20	Hex. 17	Hex. 17
IAP65PN CS	10X6.5 Hose	43.0	17	20	Hex. 17	Hex. 17
IAP80PN CS	12X8 Hose	45.0	19	20	Hex. 19	Hex. 19
IAP110PN CS	16X12 Hose	52.0	23	20	Hex. 23	Hex. 23
IAP100PN CS	14X10 Hose					

# AIRPIPE DIAMETER SELECTION

AIRPIPE Selection Chart											
Flow	Flow	Length in metre									
cub feet /min	cub m/hour	50m	100m	150m	300m	500m	750m	1000m	1300m	1600m	2000m
6	10	20	20	20	20	20	20	20	25	25	25
18	30	20	20	20	25	25	25	25	25	25	32
30	50	20	25	25	25	25	25	32	32	32	32
41	70	25	25	25	25	32	32	40	40	40	40
59	100	25	25	32	32	32	40	40	40	40	50
88	150	32	32	32	32	40	40	40	50	50	50
147	250	32	32	40	40	50	50	50	50	50	50
206	350	32	40	40	50	50	50	63	63	63	63
294	500	40	40	50	50	63	63	63	63	63	63
441	750	40	50	50	50	63	63	63	80	80	80
588	1000	50	50	63	63	63	80	80	100	100	100
736	1250	50	50	63	63	63	100	100	100	100	100
883	1500	50	63	63	80	80	100	100	100	100	100
1030	1750	63	63	80	80	80	100	100	100	100	150
1177	2000	63	80	80	80	100	100	100	100	150	150
1471	2500	63	80	80	80	100	100	100	150	150	150
1766	3000	80	80	80	100	100	150	150	150	150	150
2060	3500	80	80	100	100	150	150	150	150	150	150
2354	4000	80	100	100	100	150	150	150	150	150	150
2649	4500	80	100	100	150	150	150	150	150	150	150
2942	5000	80	100	100	150	150	150	150	150	150	150
3237	5500	100	100	100	150	150	150	150	150	150	150
3531	6000	100	100	150	150	150	150	150	150	150	150
3826	6500	150	150	150	150	150	150	150	150	150	200
4238	7200	150	150	150	150	150	150	150	200	200	200
4709	8000	200	200	200	200	200	200	200	200	200	200
5002	8500	200	200	200	200	200	200	200	200	200	200
5886	10000	200	200	200	200	200	200	200	200	200	200
7063	12000	200	200	200	200	200	200	200	200	200	200

